

Needham Subdivision

of the West 15 acres of N.W. 1/4 of N.W. 1/4 of Sec. 29

T. 1 N. R. 9 W. S. B. 1 M. Los Angeles Co. Cal.

Scale 100 ft to 1 in.

(Reduced to scale of 150 feet to one inch)

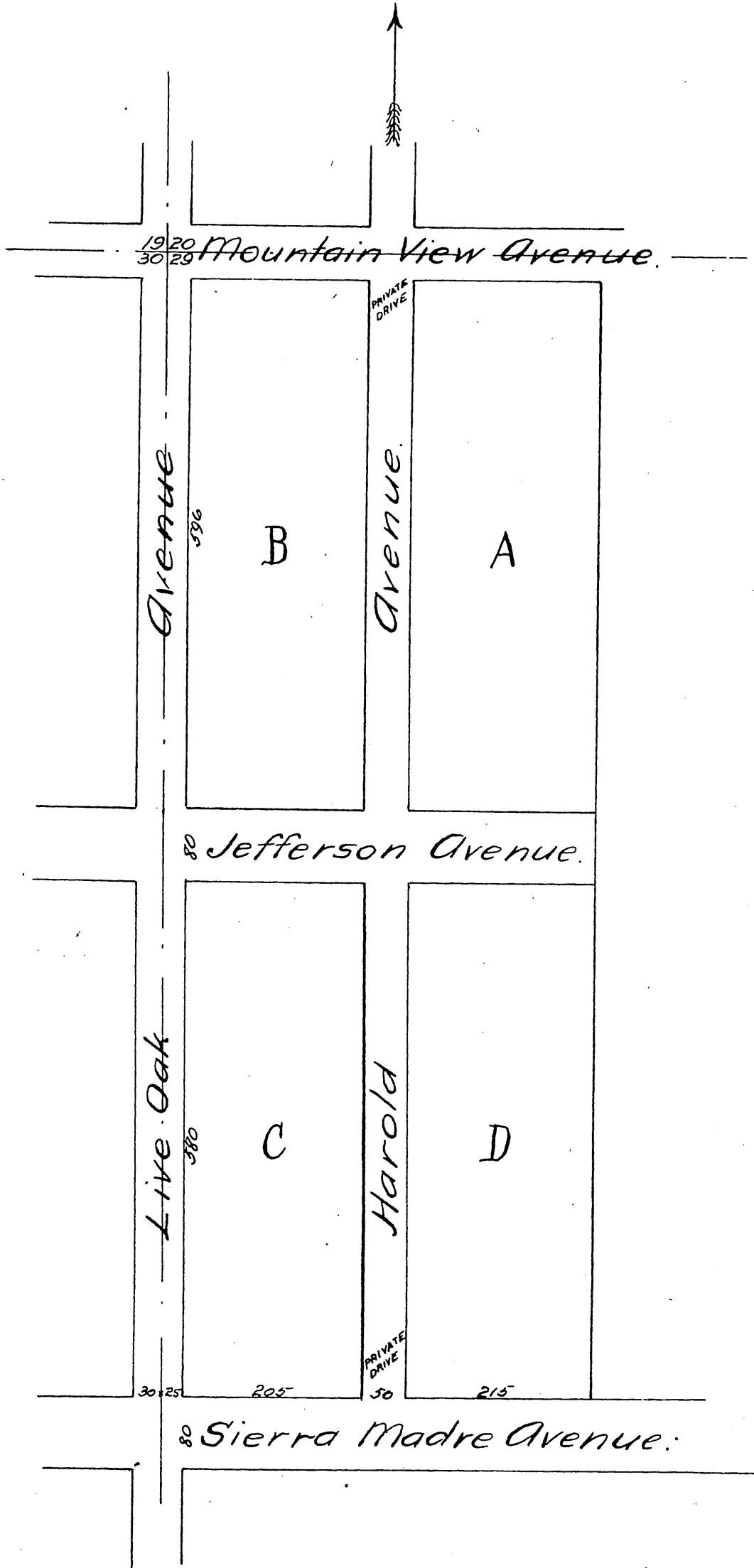

A full, true and correct copy of the original
recorded June 16, 1887 at 30 min past 11 A.M.
at request of C. E. Needham.

Frank A. Gibson County Recorder.

By George Kuyke Deputy.