

Map OF The Bowker Tract Los Angeles Co. Cal.

Being a portion of the NW 1/4 of N.W 1/4 of Sec 6 T.25 R.13 W.S.B.M.
 Surveyed at request of C.M. Bowker. Esq.
 Jan 1887 by W.H. Tinker. C.E.
 Scale 50ft = 1 in.

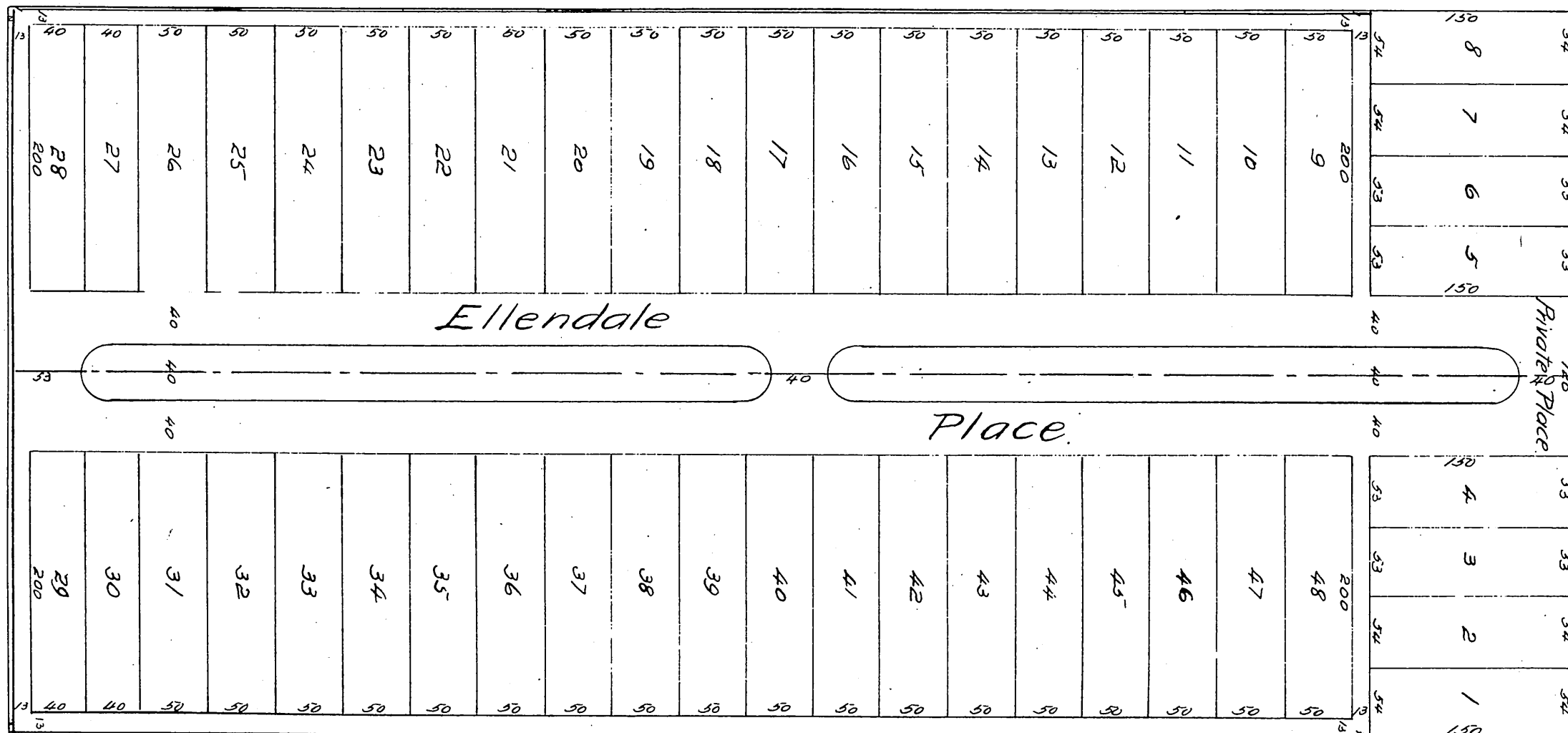

Adams St.
57th St.

Los Angeles California July 5th 1887
 The title of the above map, to wit: The Bowker Tract being erroneous said map is hereby amended by striking out the words "The Bowker Tract" in the title thereof and inserting the words "Ellendale Place" by which name and title the said map and the tract thereon delineated is henceforth to be known.
 E.S.C. Bowker Owner.
 J. M. Bowker.
 W. H. Tinker.

A full, true and correct copy of the original, recorded Aug 26, 1887 at 11²⁰ A.M. at request of W. H. Maurice.
 Frank A. Gibson Co. Recorder.
 By George Kuyler Deputy.

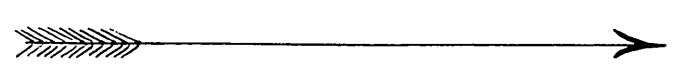

A full, true and correct copy of the original (reduced to the scale of 100 feet to one inch) recorded June 30 1887 at 43 min. past 11 A.M. at request of Mrs Ellen S.C. Bowker.
 Frank A. Gibson County Recorder.
 George Kuyler Deputy.