

# Willis Addition

Downey City

Los Angeles Co. Cal.

D.A. Sovereign Surveyor

Scale 60 ft to 1 inch.

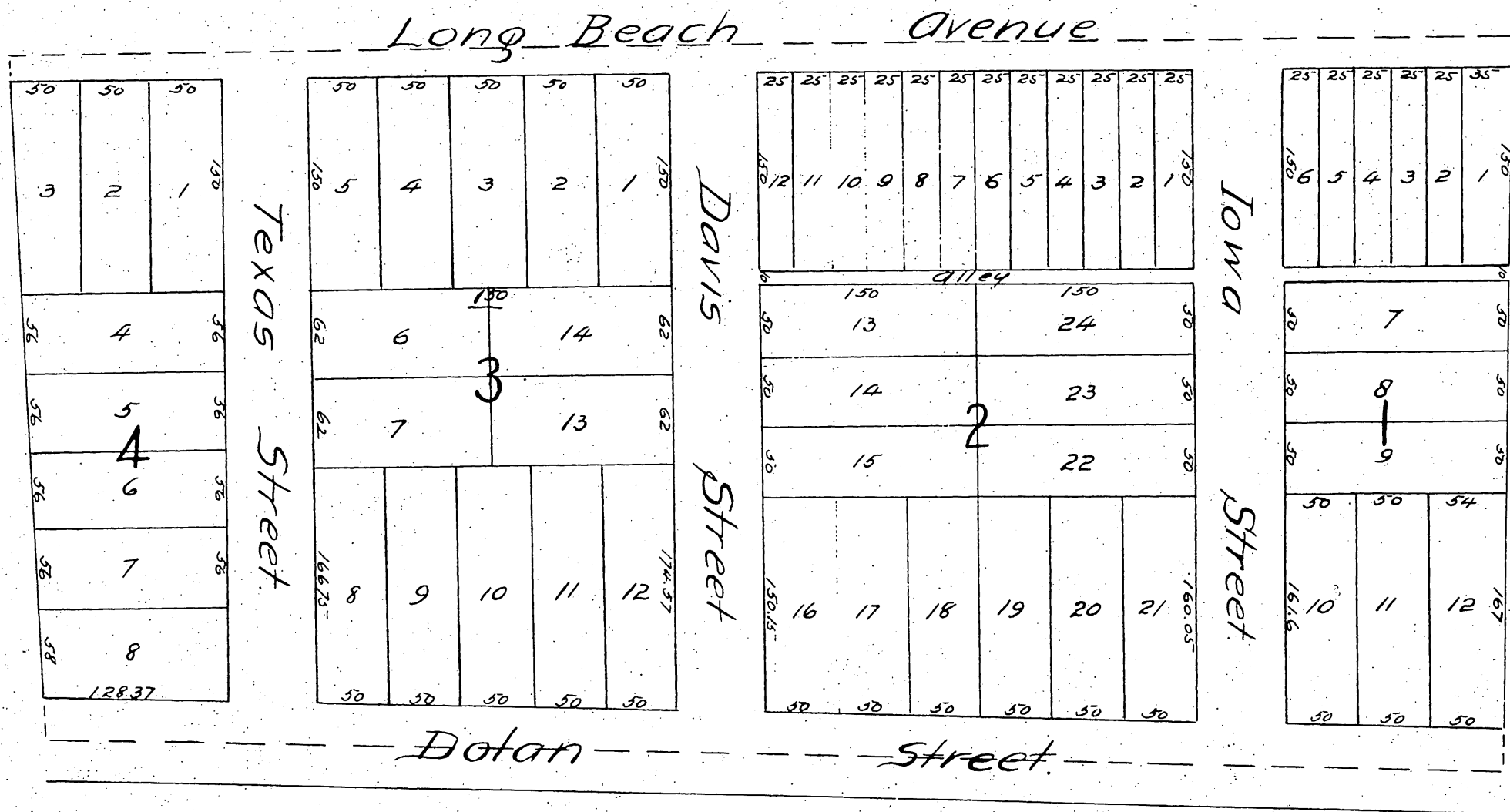
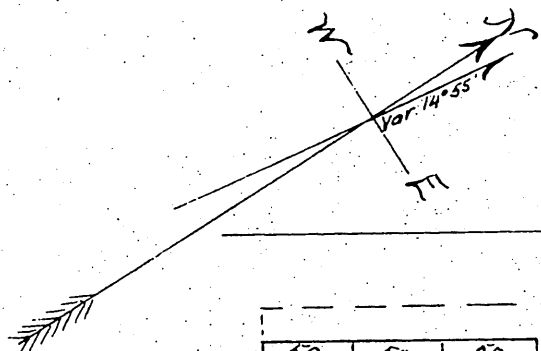

A full, true and correct copy of the original  
 (reduced to the scale of 100 feet to one inch),  
 recorded July 1 1887 at 43 m in post 11 A.M.  
 at request of F. R. Willis.  
 Frank A. Gibson County Recorder  
 By George Kuyper Deputy.