

# Oak Grove Subdivision,

Being part of Lot 10, Santa Anita Tract,

## Monrovia,

Los Angeles County, Cal.

Subdivided by J.S. McDonald C.E. Monrovia  
Scale 1 inch = 80 ft.

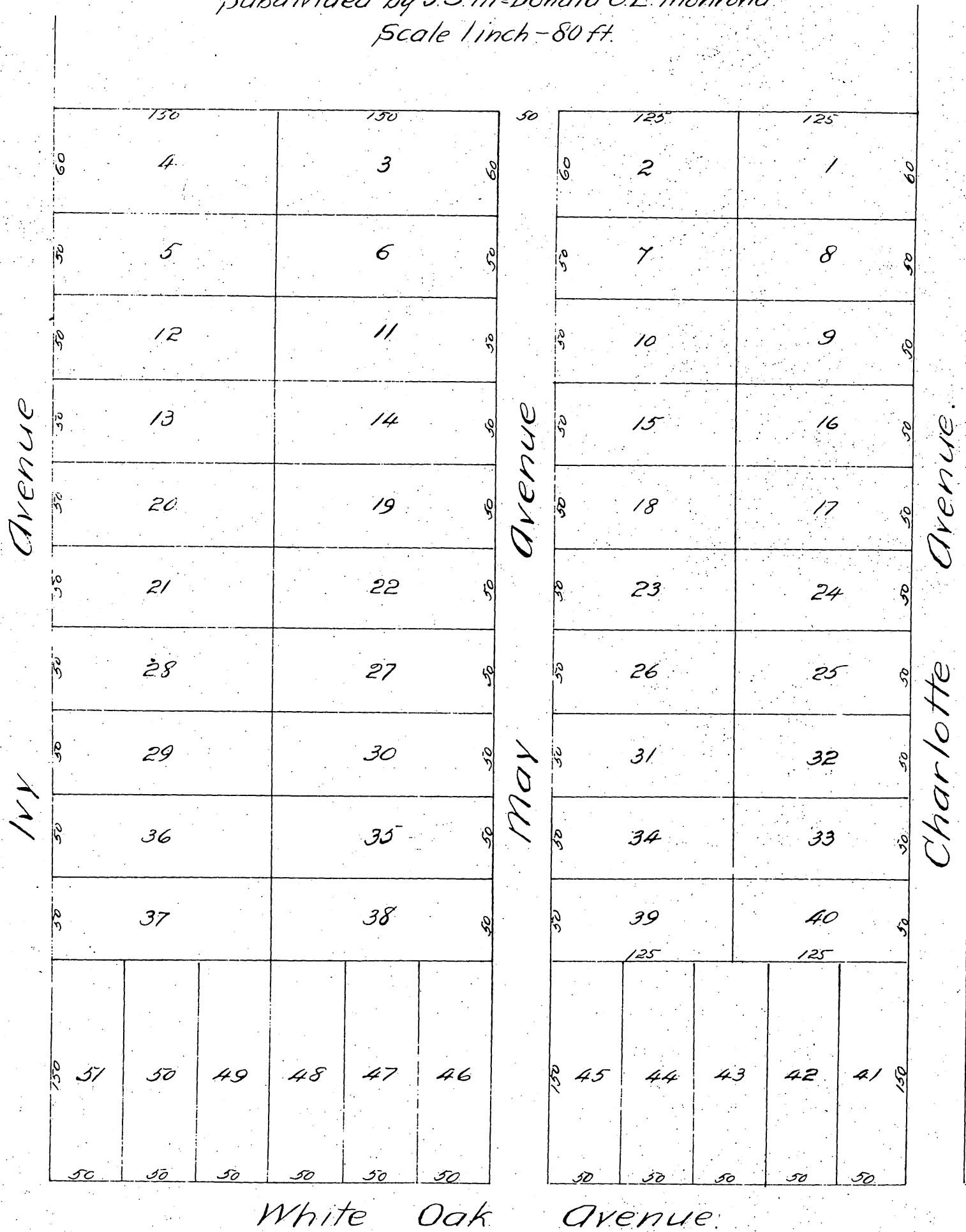

A full, true and correct copy of the original  
recorded July 6, 1887 at 3 min. past 11 A.M.  
at request of J.S. Keefer  
Frank A. Gibson County Recorder.  
By George Leugbee Deputy.