

MAP
 of the
Chester Tract
 Being the amended map of the Chester Tr.
 Recorded in Book 14, Page 29 Misc Records
 Los Angeles Co Cal.
 as surveyed July 1887 by E. G. Jones.
 Scale 100 to 1 inch.

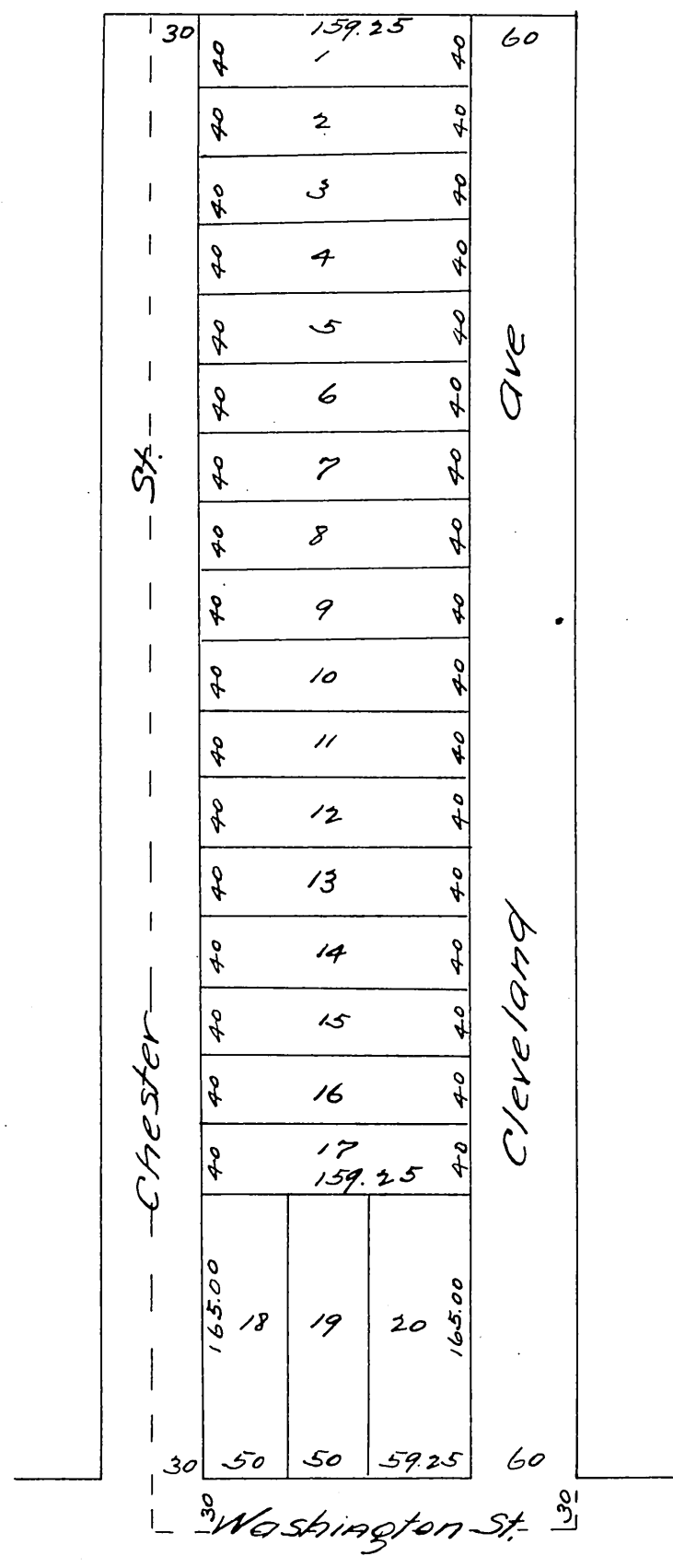

a full, true and correct copy of the original.
 Recorded July 14th 1887 at 40 min Past 10 A.M.
 at request of F. Chester.
 Frank G. Gibson County Recorder.
 By Wm E Johnston Deputy.