

Gardner & Farris Subdivision

of a portion of Lots 4 and 5 Block "Q"

SAN PASQUAL TRACT.

Land of the L.V.L. & W. Co.

as surveyed by P. R. Riggins.

June 2nd '87

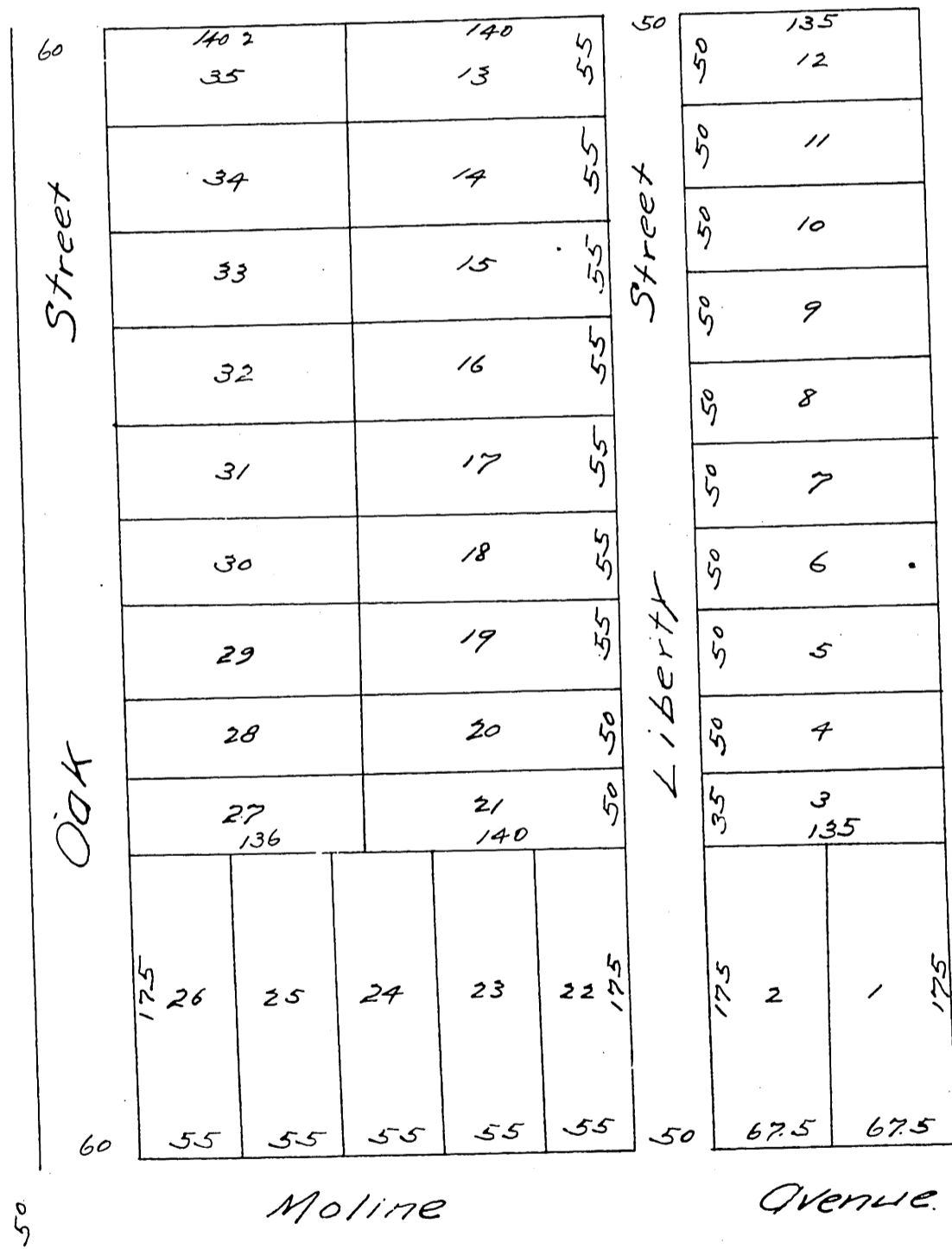

A full, true and correct copy of the original recorded July 14 1887 at 2²⁶ f. mat request of Chas A Gardner.

Frank A. Gibson County Recorder.

By Wm E. Johnston Deputy.

APPENDIX to above map.

The stake at the south east corner of lot (12) twelve (said lot faces north) is located at the south east corner of lot five (5) Block Q, San Pasqual tract, Land of the Lake Vineyard Land and Water Association as shown on a map recorded in book 3, Page 315 miscellaneous records of said Los Angeles County California

Chas A Gardner (Seal)
Edwin L. Farris (Seal)