

MAP OF CLEARWATER.

IN THE California Cooperative Colony Tract

Los Angeles Co., Cal.
Q.R. Street Surveyor May 1887.

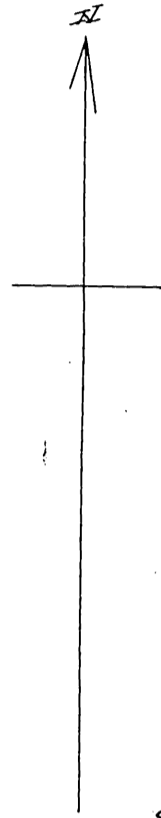

Scale 300ft. to 1 inch.

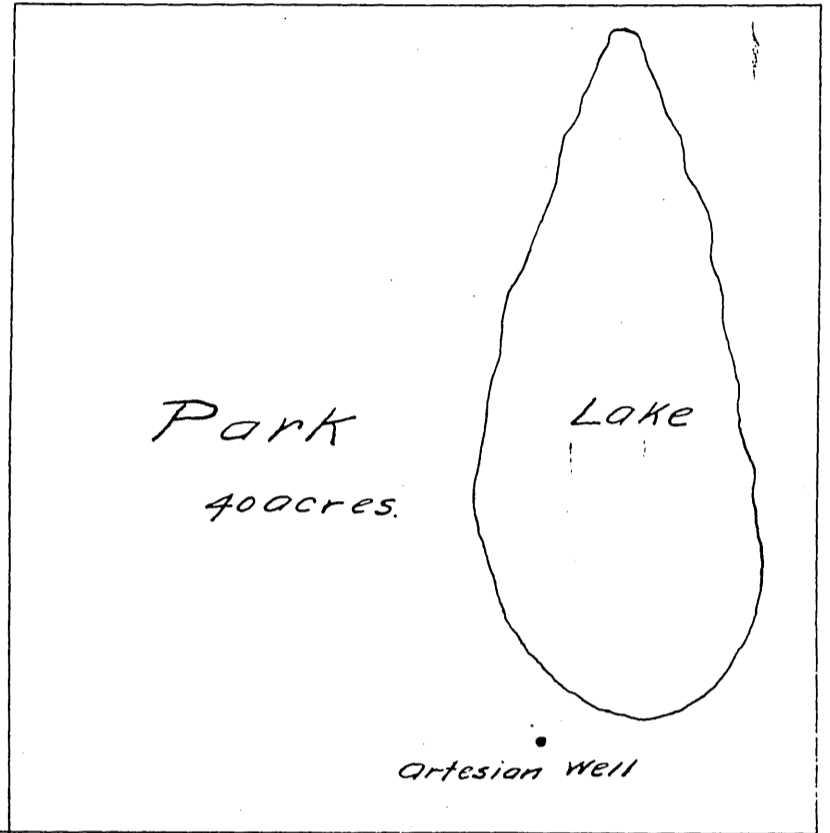

County Road from Compton.

Washington

390 500	150 100	150 100	150 100	150 100	150 100	150 100	150 100	150 100	150 100	150 100	150 100
	2 "	" 2 "	" 2 "	" 2 "	" 2 "	" 2 "	" 2 "	" 2 "	" 2 "	" 2 "	" 2 "
	3 "	" 3 "	" 3 "	" 3 "	" 3 "	" 3 "	" 3 "	" 3 "	" 3 "	" 3 "	" 3 "
	4 "	" 4 "	" 4 "	" 4 "	" 4 "	" 4 "	" 4 "	" 4 "	" 4 "	" 4 "	" 4 "
	5 "	" 5 "	" 5 "	" 5 "	" 5 "	" 5 "	" 5 "	" 5 "	" 5 "	" 5 "	" 5 "
	6 "	" 6 "	" 6 "	" 6 "	" 6 "	" 6 "	" 6 "	" 6 "	" 6 "	" 6 "	" 6 "

Adams

600 24	100 1	100 1	100 1	100 1	100 1	100 1	100 1	100 1	100 1	100 1	100 1
	2 "	" 2 "	" 2 "	" 2 "	" 2 "	" 2 "	" 2 "	" 2 "	" 2 "	" 2 "	" 2 "
	3 "	" 3 "	" 3 "	" 3 "	" 3 "	" 3 "	" 3 "	" 3 "	" 3 "	" 3 "	" 3 "
	4 "	" 4 "	" 4 "	" 4 "	" 4 "	" 4 "	" 4 "	" 4 "	" 4 "	" 4 "	" 4 "
	5 "	" 5 "	" 5 "	" 5 "	" 5 "	" 5 "	" 5 "	" 5 "	" 5 "	" 5 "	" 5 "
	6 "	" 6 "	" 6 "	" 6 "	" 6 "	" 6 "	" 6 "	" 6 "	" 6 "	" 6 "	" 6 "

Jefferson

600 25	100 1	100 1	100 1	100 1	100 1	100 1	100 1	100 1	100 1	100 1	100 1
	2 "	" 2 "	" 2 "	" 2 "	" 2 "	" 2 "	" 2 "	" 2 "	" 2 "	" 2 "	" 2 "
	3 "	" 3 "	" 3 "	" 3 "	" 3 "	" 3 "	" 3 "	" 3 "	" 3 "	" 3 "	" 3 "
	4 "	" 4 "	" 4 "	" 4 "	" 4 "	" 4 "	" 4 "	" 4 "	" 4 "	" 4 "	" 4 "
	5 "	" 5 "	" 5 "	" 5 "	" 5 "	" 5 "	" 5 "	" 5 "	" 5 "	" 5 "	" 5 "
	6 "	" 6 "	" 6 "	" 6 "	" 6 "	" 6 "	" 6 "	" 6 "	" 6 "	" 6 "	" 6 "

Madison

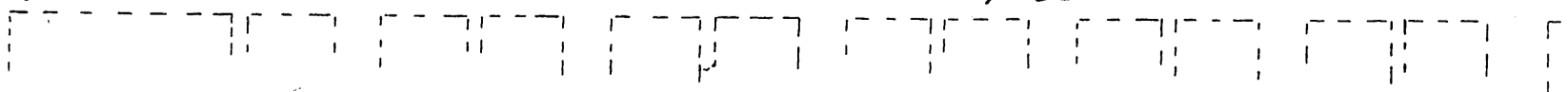

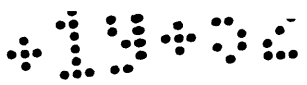

MR-19-52

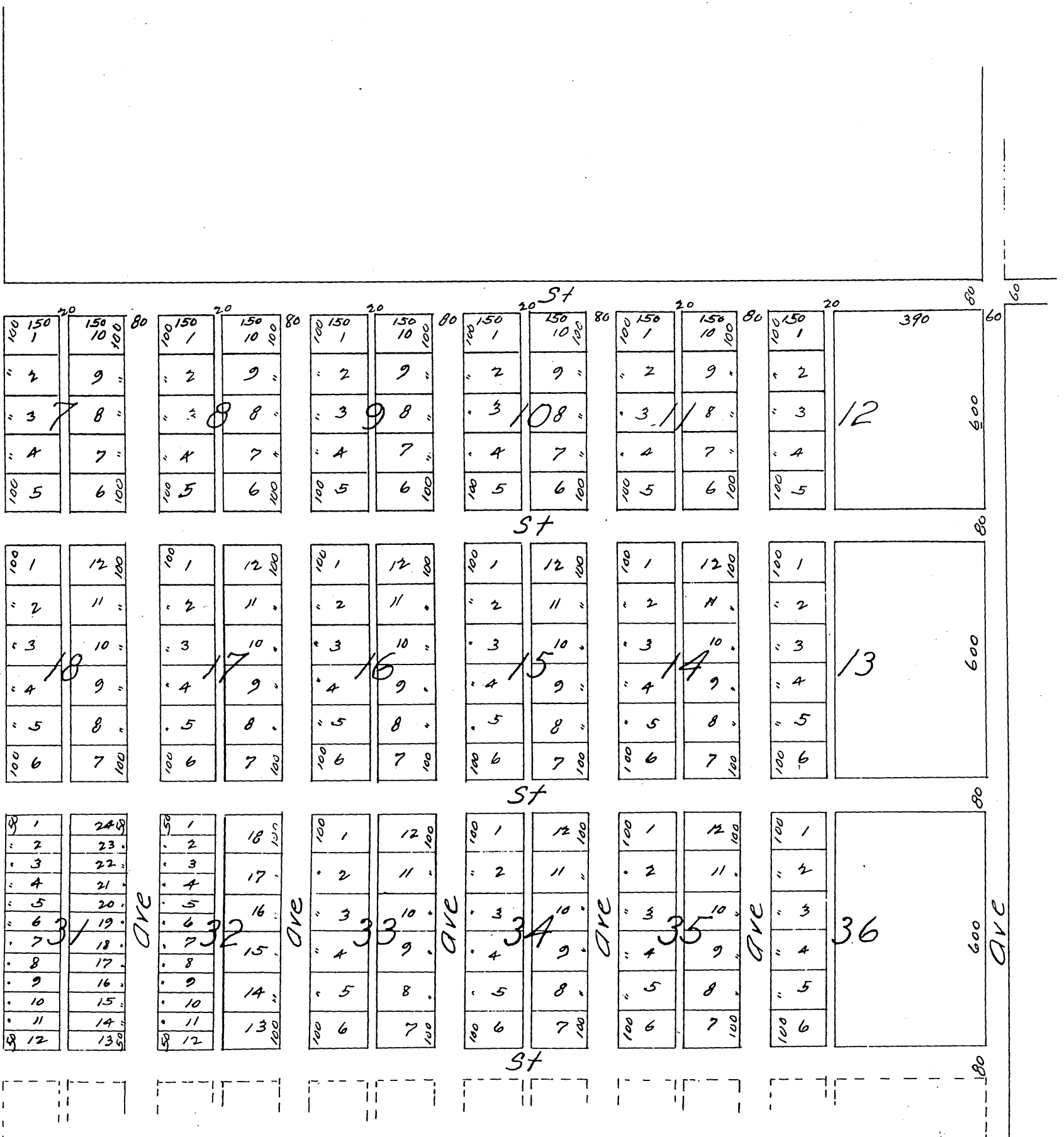

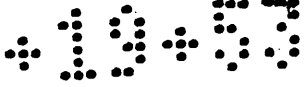

600	48	1	100	100	1	12	100	100	1	12	100	100	1	12	100	100	1	18	80	50	1	36	60				
		2	"		2	"	2		"	2	"		2	17	2		34										
		3	"		3	10	3		10	3	10		3	16	3		32										
		4	"		4	9	4		9	4	9		4	15	4		31										
		5	"		5	8	5		8	5	8		5	14	5		28										
		6	100		6	7	6		7	6	7		6	13	6		26										
Center																											
600	49	1	100	100	1	12	100	100	1	12	100	100	1	12	100	100	1	18	80	50	1	36	60				
		2	"		2	"	2		"	2	"		2	17	2		34										
		3	"		3	10	3		10	3	10		3	16	3		32										
		4	"		4	9	4		9	4	9		4	15	4		31										
		5	"		5	8	5		8	5	8		5	14	5		28										
		6	100		6	7	6		7	6	7		6	13	6		26										
Monroe																											
600	72	1	100	100	1	12	100	100	1	12	100	100	1	12	100	100	1	18	80	50	1	36	60				
		2	"		2	"	2		"	2	"		2	17	2		34										
		3	"		3	10	3		10	3	10		3	16	3		32										
		4	"		4	9	4		9	4	9		4	15	4		31										
		5	"		5	8	5		8	5	8		5	14	5		28										
		6	100		6	7	6		7	6	7		6	13	6		26										
Jackson																											
600	73	1	100	100	1	12	100	100	1	12	100	100	1	12	100	100	1	12	100	100	1	18	80	50	1	36	60
		2	"		2	"	2		"	2	"		2	"	2		17	2	34								
		3	"		3	10	3		10	3	10		3	16	3		32										
		4	"		4	9	4		9	4	9		4	15	4		31										
		5	"		5	8	5		8	5	8		5	14	5		28										
		6	100		6	7	6		7	6	7		6	13	6		26										
Harrison																											
500	96	1	100	100	1	10	100	100	1	10	100	100	1	10	100	100	1	10	100	100	1	10	100	100	1	10	100
		2	"		2	9	2		9	2	9		2	9	2		9	2	9								
		3	"		3	8	3		8	3	8		3	8	3		8	3	8								
		4	"		4	7	4		7	4	7		4	7	4		7	4	7								
		5	"		5	6	5		6	5	6		5	6	5		6	5	6								
		6	100		6	5	6		5	6	5		6	5	6		5	6	5								
Lincoln																											

MI. T. 9 77

MINNESOTA

ILLINOIS

OHIO

VERMONT

COLORADO

OCEAN

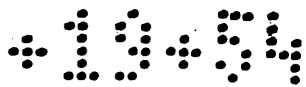

1	36	50
2	35	
3	34	
4	33	
5	32	
6	31	
7	30	
8	29	
9	28	
10	27	
11	26	
12	25	
13	24	
14	23	
15	22	
16	21	
17	20	
18	19	
19	18	
20	17	
21	16	
22	15	
23	14	
24	13	

1	18	100
2	17	
3	16	
4	15	
5	14	
6	13	
7	12	
8	11	
9	10	
10	9	
11	8	
12	7	

100	1	12	100
"	2	11	"
"	3	10	"
"	4	9	"
"	5	8	"
100	6	7	100

100	1	12	100
"	2	11	"
"	3	10	"
"	4	9	"
"	5	8	"
100	6	7	100

100	1	12	100
"	2	11	"
"	3	10	"
"	4	9	"
"	5	8	"
100	6	7	100

100	1		
"	2		
"	3		
"	4		
"	5		
100	6		

ALONDRA

E: 177-236

St

ELUD

1	36	50
2	35	
3	34	
4	33	
5	32	
6	31	
7	30	
8	29	
9	28	
10	27	
11	26	
12	25	
13	24	
14	23	
15	22	
16	21	
17	20	
18	19	
19	18	
20	17	
21	16	
22	15	
23	14	
24	13	

1	18	100
2	17	
3	16	
4	15	
5	14	
6	13	
7	12	
8	11	
9	10	
10	9	
11	8	
12	7	

100	1	12	100
"	2	11	"
"	3	10	"
"	4	9	"
"	5	8	"
100	6	7	100

100	1	12	100
"	2	11	"
"	3	10	"
"	4	9	"
"	5	8	"
100	6	7	100

100	1	12	100
"	2	11	"
"	3	10	"
"	4	9	"
"	5	8	"
100	6	7	100

100	1		
"	2		
"	3		
"	4		
"	5		
100	6		

California

Pennsylvania

Georgia

Virginia

Indiana

New York

1	24	50
2	23	
3	22	
4	21	
5	20	
6	19	
7	18	
8	17	
9	16	
10	15	
11	14	
12	13	

1	18	100
2	17	
3	16	
4	15	
5	14	
6	13	
7	12	
8	11	
9	10	
10	9	
11	8	
12	7	

100	1	12	100
"	2	11	"
"	3	10	"
"	4	9	"
"	5	8	"
100	6	7	100

100	1	12	100
"	2	11	"
"	3	10	"
"	4	9	"
"	5	8	"
100	6	7	100

100	1	12	100
"	2	11	"
"	3	10	"
"	4	9	"
"	5	8	"
100	6	7	100

100	1		
"	2		
"	3		
"	4		
"	5		
100	6		

100	1	12	100
"	2	11	"
"	3	10	"
"	4	9	"
"	5	8	"
100	6	7	100

100	1	12	100
"	2	11	"
"	3	10	"
"	4	9	"
"	5	8	"
100	6	7	100

100	1	12	100
"	2	11	"
"	3	10	"
"	4	9	"
"	5	8	"
100	6	7	100

100	1	12	100
"	2	11	"
"	3	10	"
"	4	9	"
"	5	8	"
100	6	7	100

100	1	12	100
"	2	11	"
"	3	10	"
"	4	9	"
"	5	8	"
100	6	7	100

100	1		
"	2		
"	3		
"	4		
"	5		
100	6		

100	1	10	100
"	2	9	"
"	3	8	"
"	4	7	"
100	5	6	100
150	150	80	

100	1	10	100
"	2	9	"
"	3	8	"
"	4	7	"
100	5	6	100
150	150	80	

100	1	10	100
"	2	9	"
"	3	8	"
"	4	7	"
100	5	6	100
150	150	80	

100	1	10	100
"	2	9	"
"	3	8	"
"	4	7	"
100	5	6	100
150	150	80	

100	1	10	100
"	2	9	"
"	3	8	"
"	4	7	"
100	5	6	100
150	150	80	

100	1		
"	2		
"	3		
"	4		
100	5		
150	150	80	

a full, true and correct copy of the original Recorded July 20th 1887 at 12.46 M. at request of Ralph E Hoyt.

Frank A. Gibson County Recorder
By Wm E Johnston Deputy.