

MAP OF Manzanita Heights Tract

Being a Subdivision of the Western one half of Lots 2 and 7, BIK 34 "C and R" lands
Los Angeles City, being Division A of Lot 2 and Division C of Lot 7, BIK 34
H.S. of Los Angeles Donation Lots, surveyed and subdivided
June 1887 under instructions from Dr. F. A. Sanborn by
F. D. Lanterman Sur.

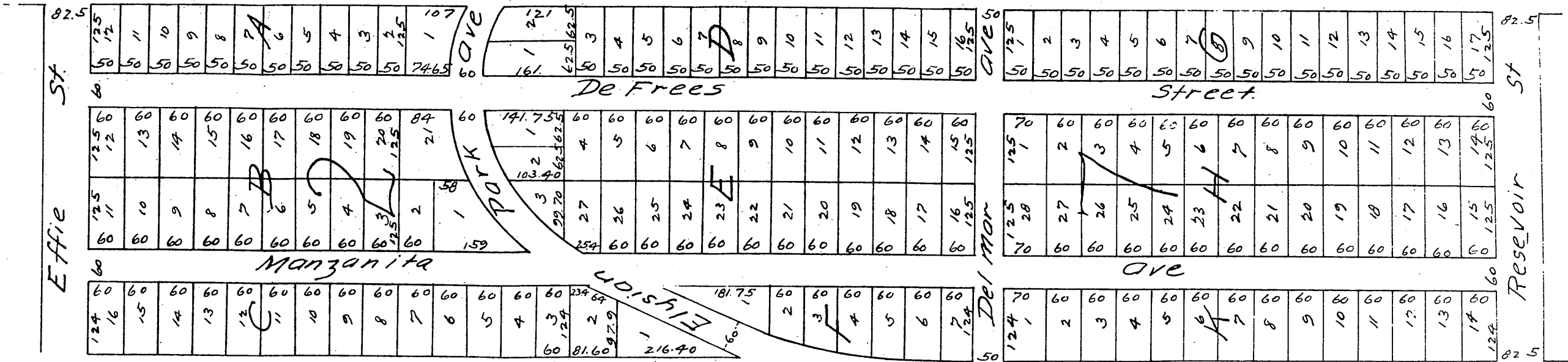

A full, true and correct copy of the original (reduced to scale of 200 feet
to one inch) Recorded July 22nd 1887 at 10:56 a.m. at request of F. A. Sanborn.
Frank A. Gibson Co Recorder.
B. W. E. Johnston Deputy.

