

Gregory's Subdivision
 OF
Lowell's Subdivision of Lots Fifteen (15), Sixteen (16) & Seventeen (17)
 of the *Sheiffelin Tract East Los Angeles.*
 recorded in *Book 9 Page 41 Miscellaneous Records*
 of *Los Angeles Co. Cal.*

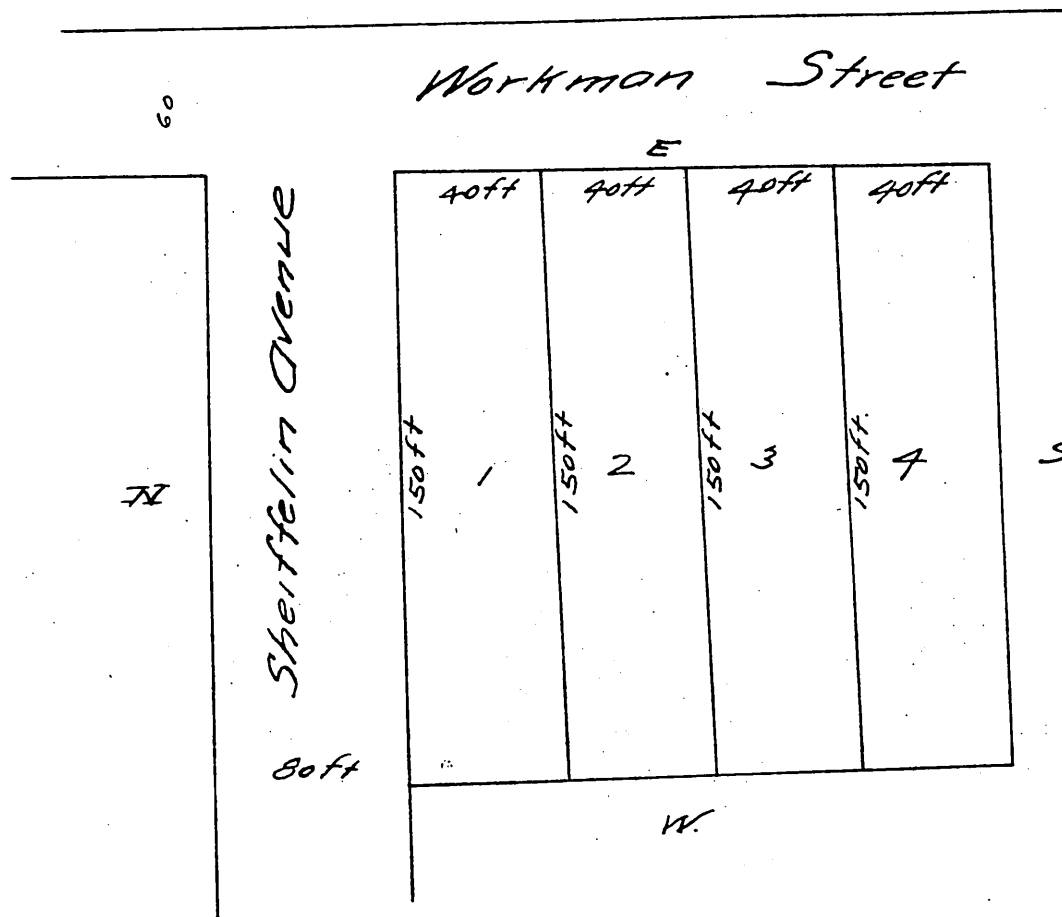

A full, true and correct copy of the original, Recorded July 26th
1887 at 10.40 A. M. at request of C. W. Gregory
Frank Q Gibson Co. Recorder.
By W^m E Johnston Deputy.