

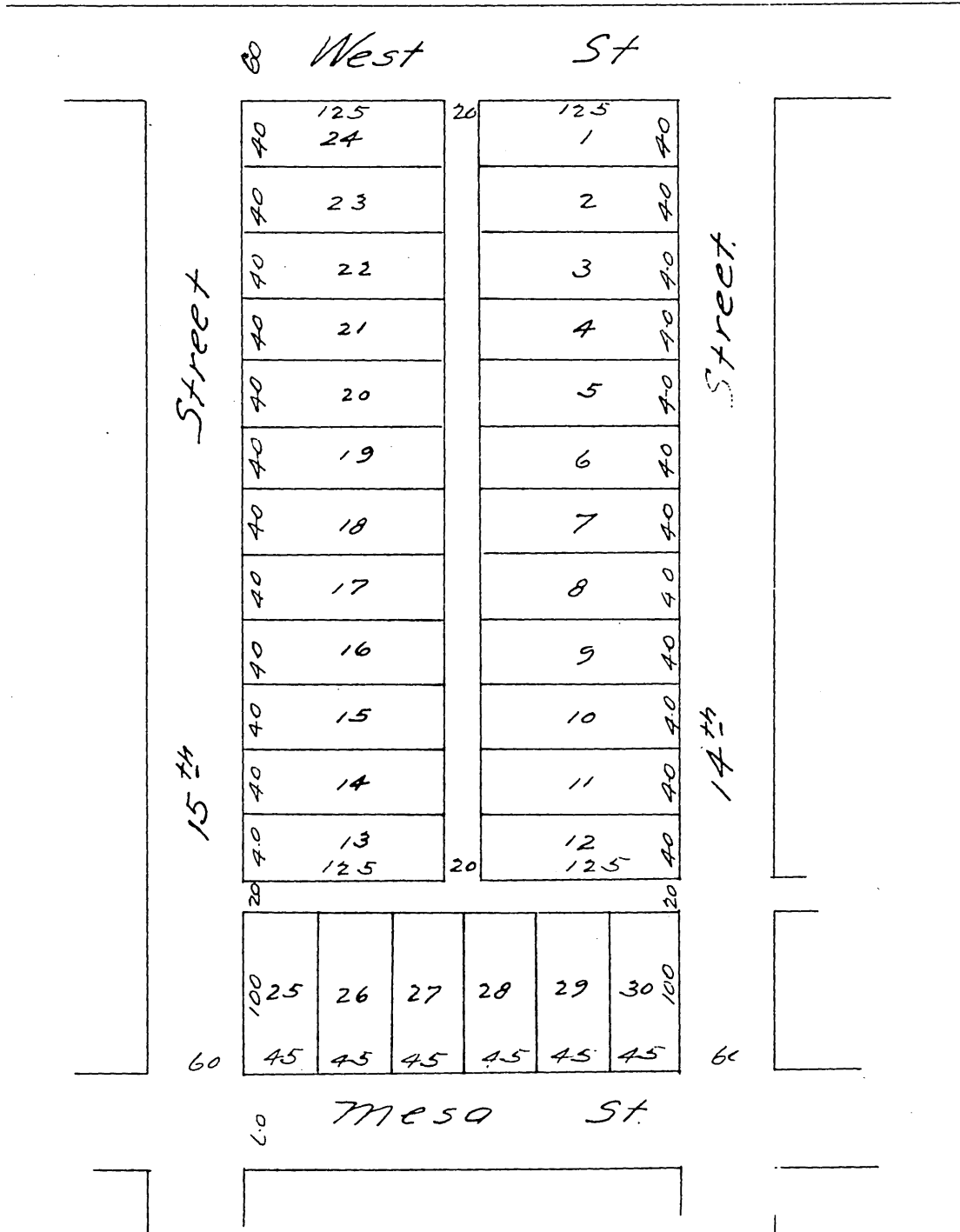

Plat  
of  
Jordan's Subdivision  
of Block 15  
Town of San Pedro  
Scale 100 feet to one inch.



a full, true and correct of the original. Recorded  
July 29<sup>th</sup> 1887 at 12:15 P.M. at request of G. W. Peck Jr.  
Frank A. Gibson, Recorder.  
By W<sup>m</sup> E. Johns, Deputy.