

PLAT
OF
Amar's Subdivision
of Block 10
Town of San Pedro
Scale: 100 feet to one inch.

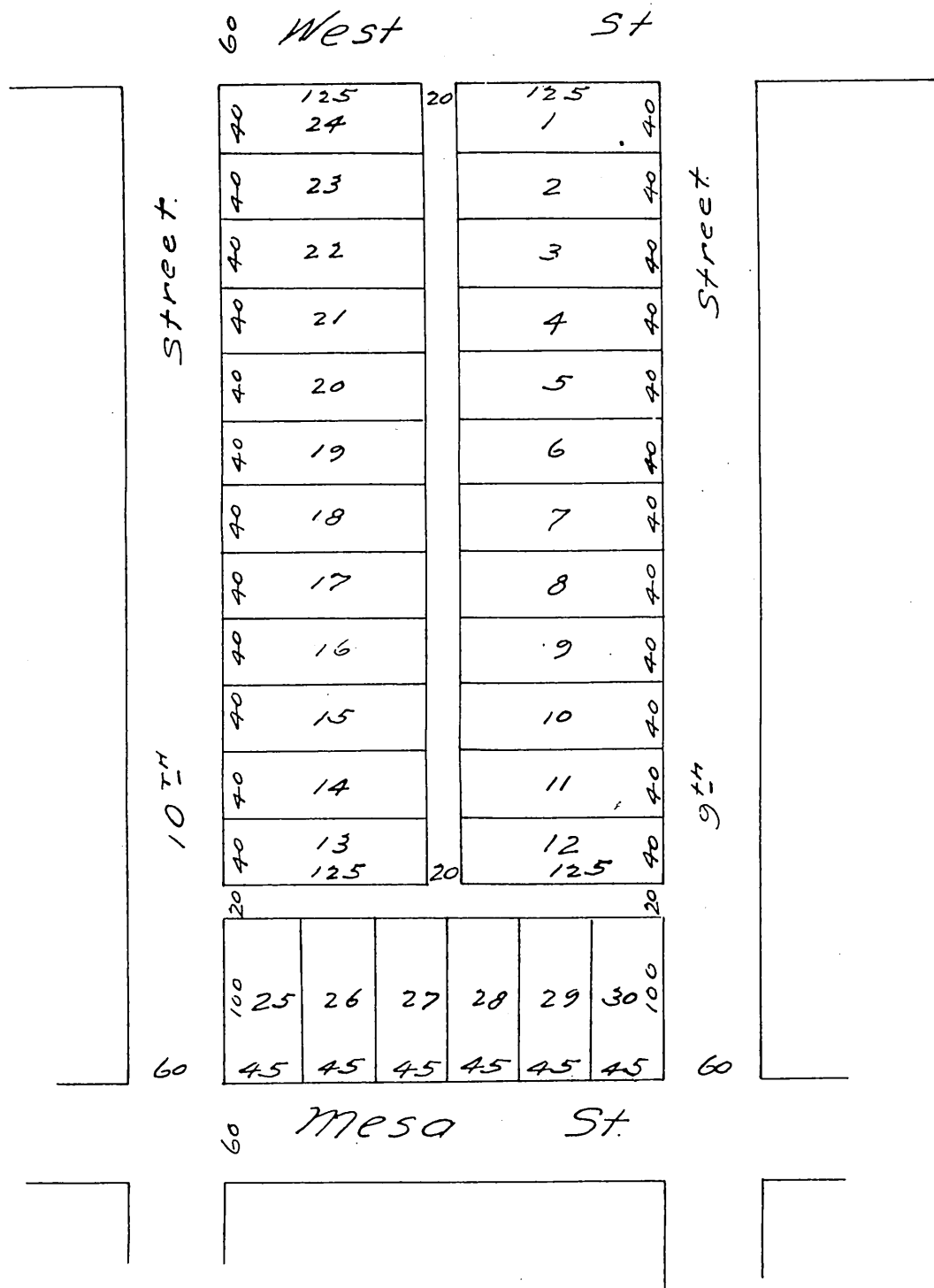

A full, true and correct copy of the original, recorded
 July 29 1887 at 12¹⁸mat request of Geo. H. Peck, Jr.
 Frank C. Gibson County Recorder
 By W^m E. Johnston Deputy.