

Map  
of  
Sepulveda's Subdivision  
of Block 5  
Town of San Pedro  
Scale 100 feet to one inch.

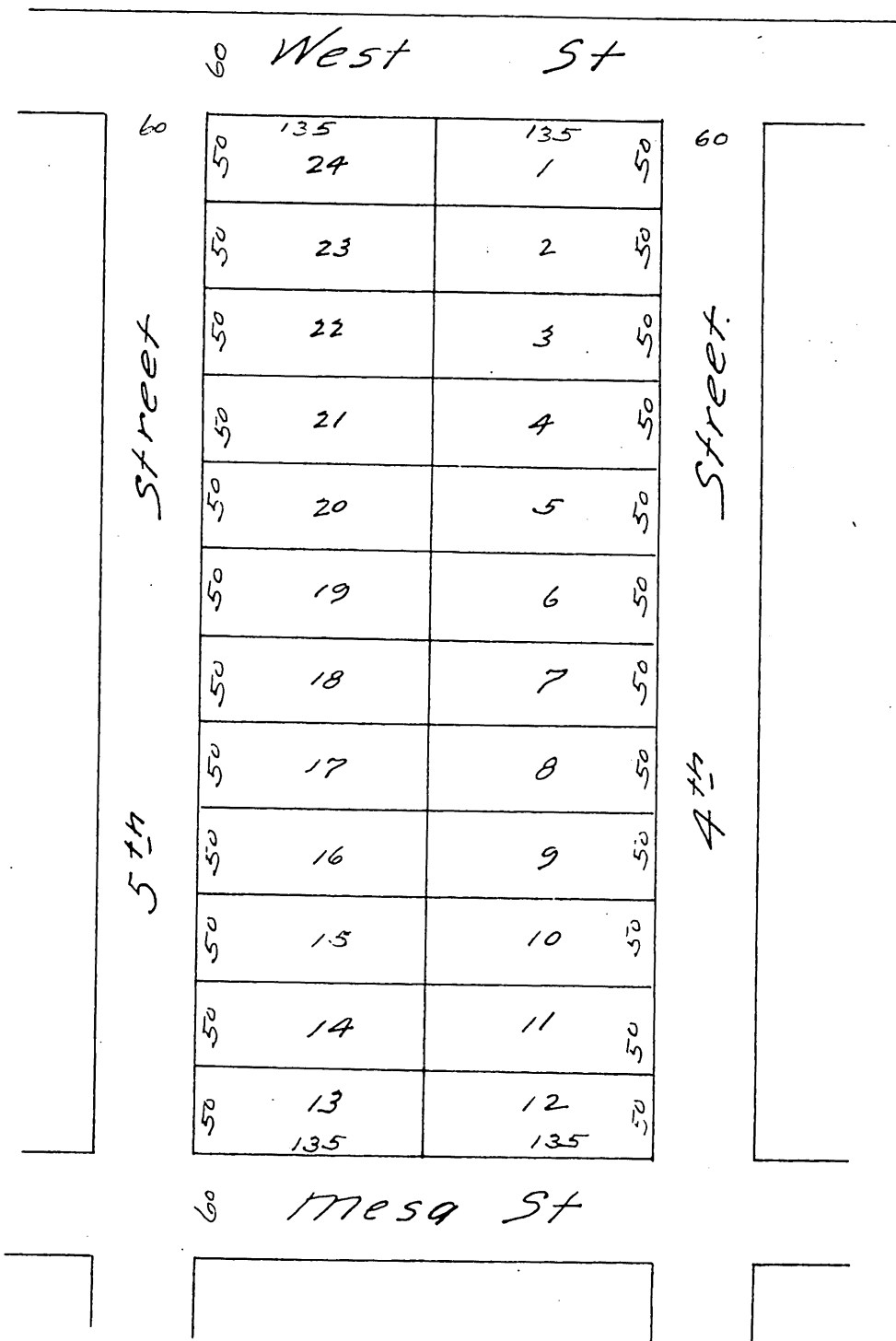

A full true and correct copy of the original recorded  
July 29<sup>th</sup> 1887 at 2<sup>46</sup> P.M. at request of R. D. Sepulveda.  
Frank A. Gibson County Recorder.  
By W<sup>m</sup> E. Johnston Deputy.