

Map

of the

Crisp and Steinberger Subdivision
of eleven and one third acres of the S.W. quarter of Lot 2

SIERRA MADRE CAL.

J.A. Osgood, Surveyor July 30th 1887
Scale 100 feet one inch.

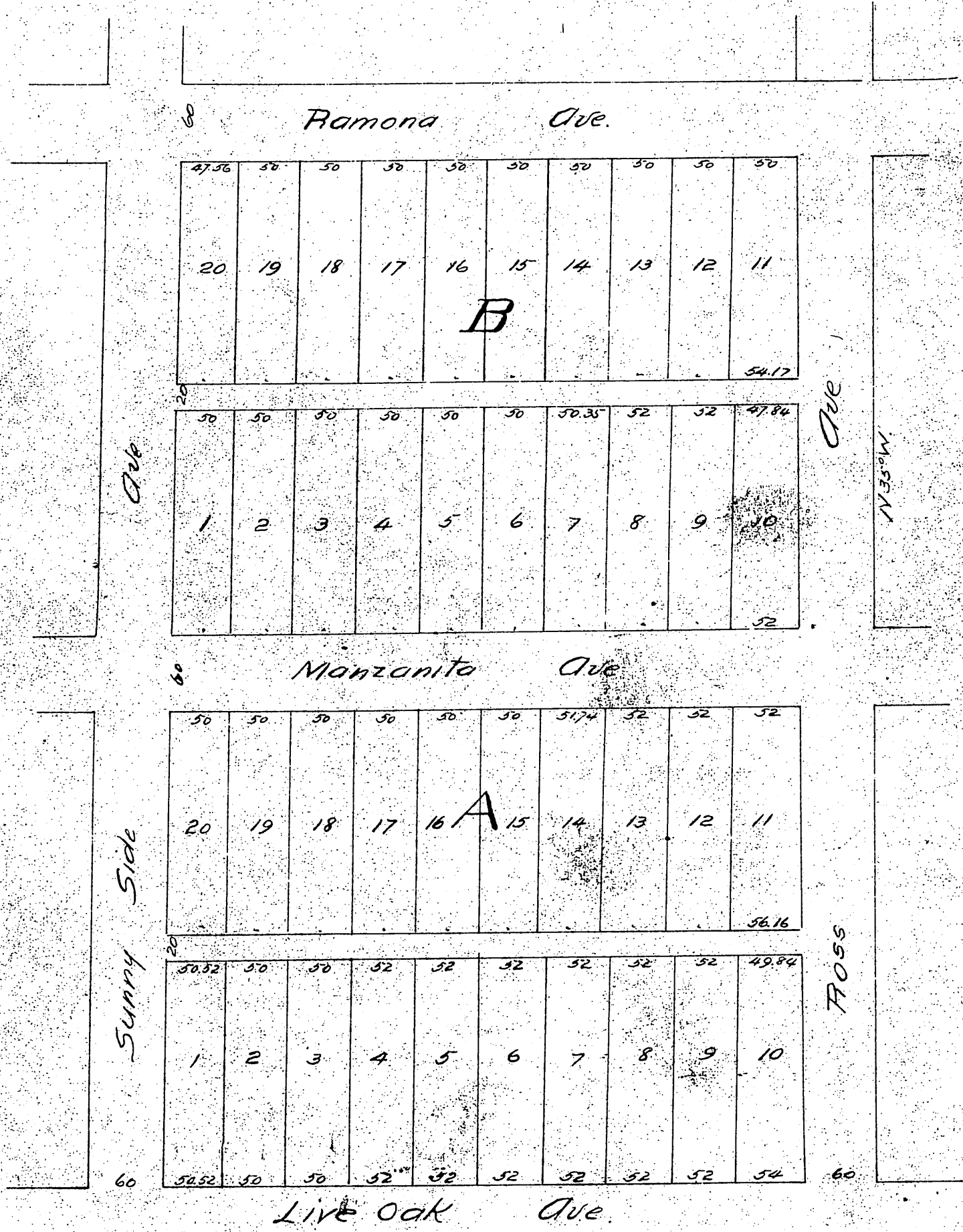

A full true and correct copy of the original recorded
August 11th 1887 at 10:40 A.M. at request of W. B. Crisp
Frank A. Gibson County Recorder
by W. E. J. Huston Deputy.