



# Map of the Mountain View Tract.

## BEING RALPH ROGERS ADDITION NO. 3. TO THE TOWN OF GARAVANZA.

Surveyed in May 1887 by M<sup>rs</sup> CLURE Bros.

BROADWAY CHANGED TO BRIDEWELL ST. ORD. 27333.  
 OLIVE ST. " " CRESCENT ST. " 27333.  
 HOPE ST. " " HOUGH ST. " 27333.  
 OHIO ST. " " ELGIN ST. " 27333.  
 FORREST ST. " " FERRARA " " 27333.  
 ORANGE ST. " " POLLARD ST. " 27333.

PORTION OF ARROYO DR " " PASADENA AVE. " 429-D:9-62  
 For Pasadena Ave See D:6433-259. D:15-122  
 Crescent St. changed to Kirby St. - ord. 36786

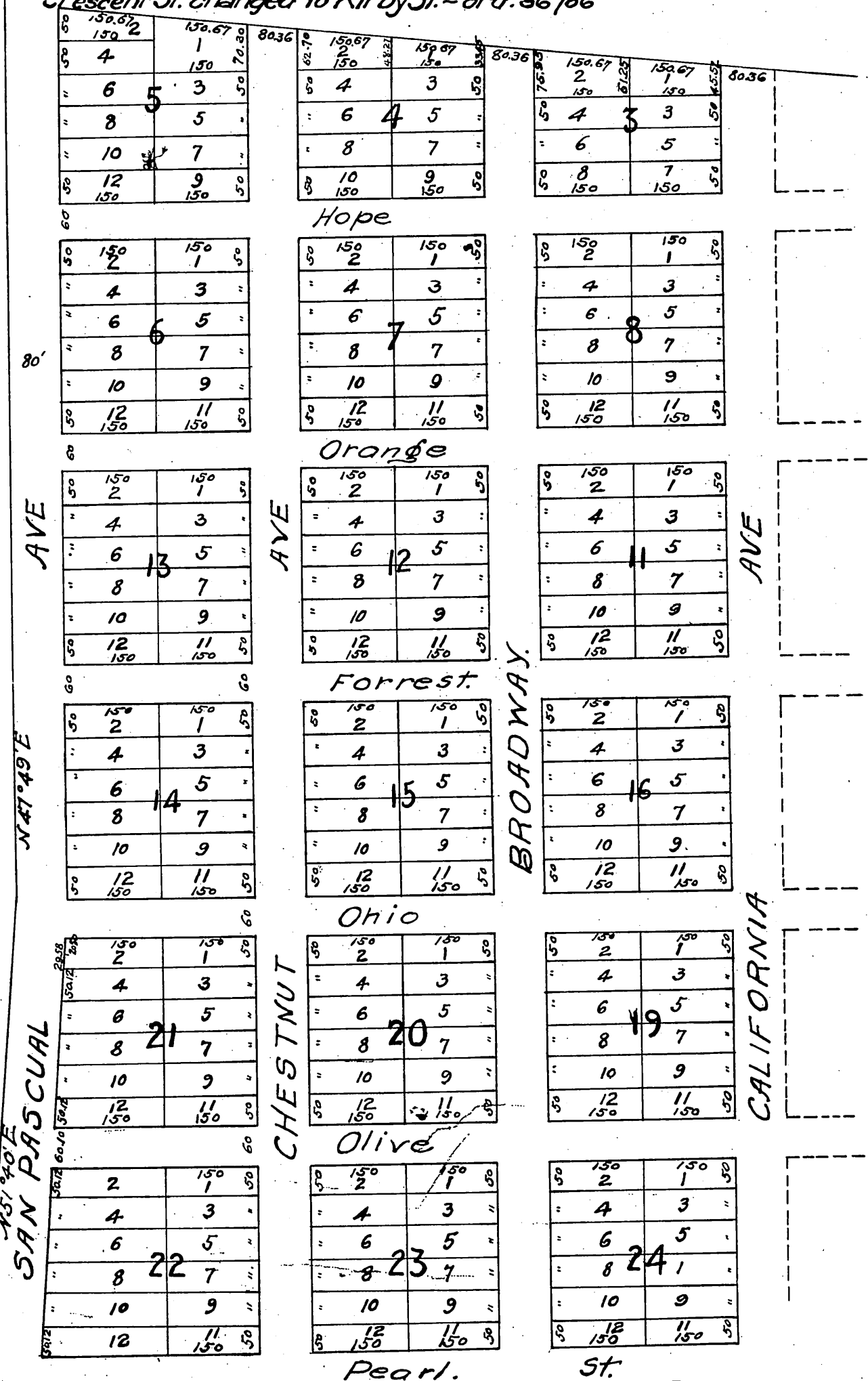

California Ave. changed to Glenbrook St. (in L.A. City) - ord. 36769  
 For 1600 Ohio St bet Bkls 15 & 20 See D:12-92  
 Kirby St. changed to Crescent St. - ord. 37131  
 Grasmere Ave. changed to Chestnut St. Ord. 49440

Por. lots 3, 5, 7, 9, 11, Bk. 24, to City of S. Pasadena D:44-96 O.R. 9951-56  
 Pearl St. changed to Princess Dr. and Chestnut Ave. changed to Grasmere Ave. Ord. 40896