

WESTMINSTER

Subdivision of

VILLA LOT FIVE

LONG BEACH TOWNSITE, CALIF.

S.R. Langworthy, C.E.

Scale 50 ft. 1 in.

1887

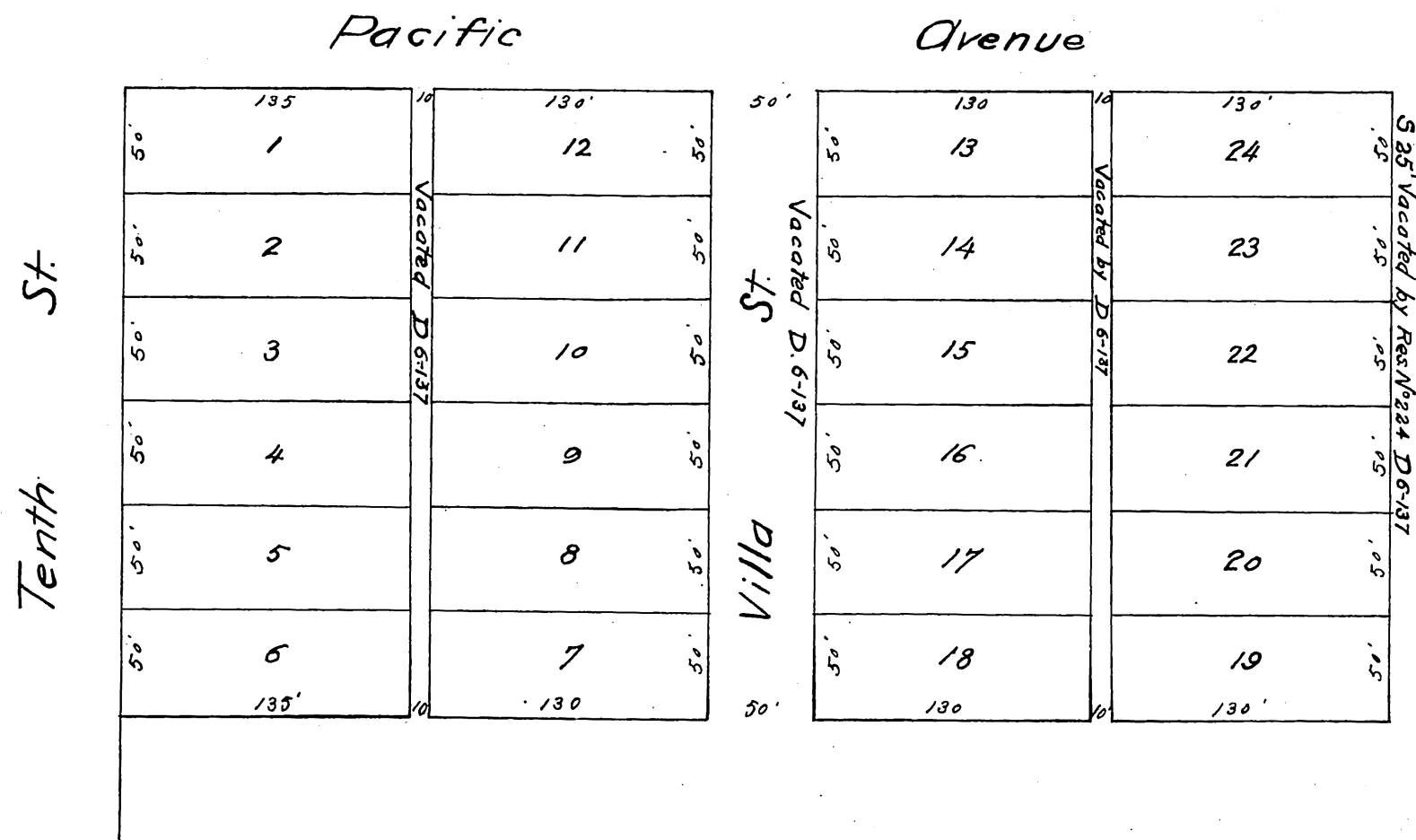

reduced to a scale of 80 feet to the inch, recorded Sept. 5, 1887, at 1:55 P.M. at request of F.B. Sitton.

For Vac. of certain Sts. & Alleys Ord. 199 D:278

Wm. D. ...