



MAP OF Strang and Baldwin's

Replat of Lots 1, 2, 12, 13, 14, 15 & 16 of Armintha Thorntons
Subdivision as recorded in Book 15 Page 16 Misc Records of

Los Angeles County, Cal.

Surveyed 1887 by Baldwin Jessup & Co.
Scale 60 ft to 1 inch.

Cambell & Marsh Draughtsmen

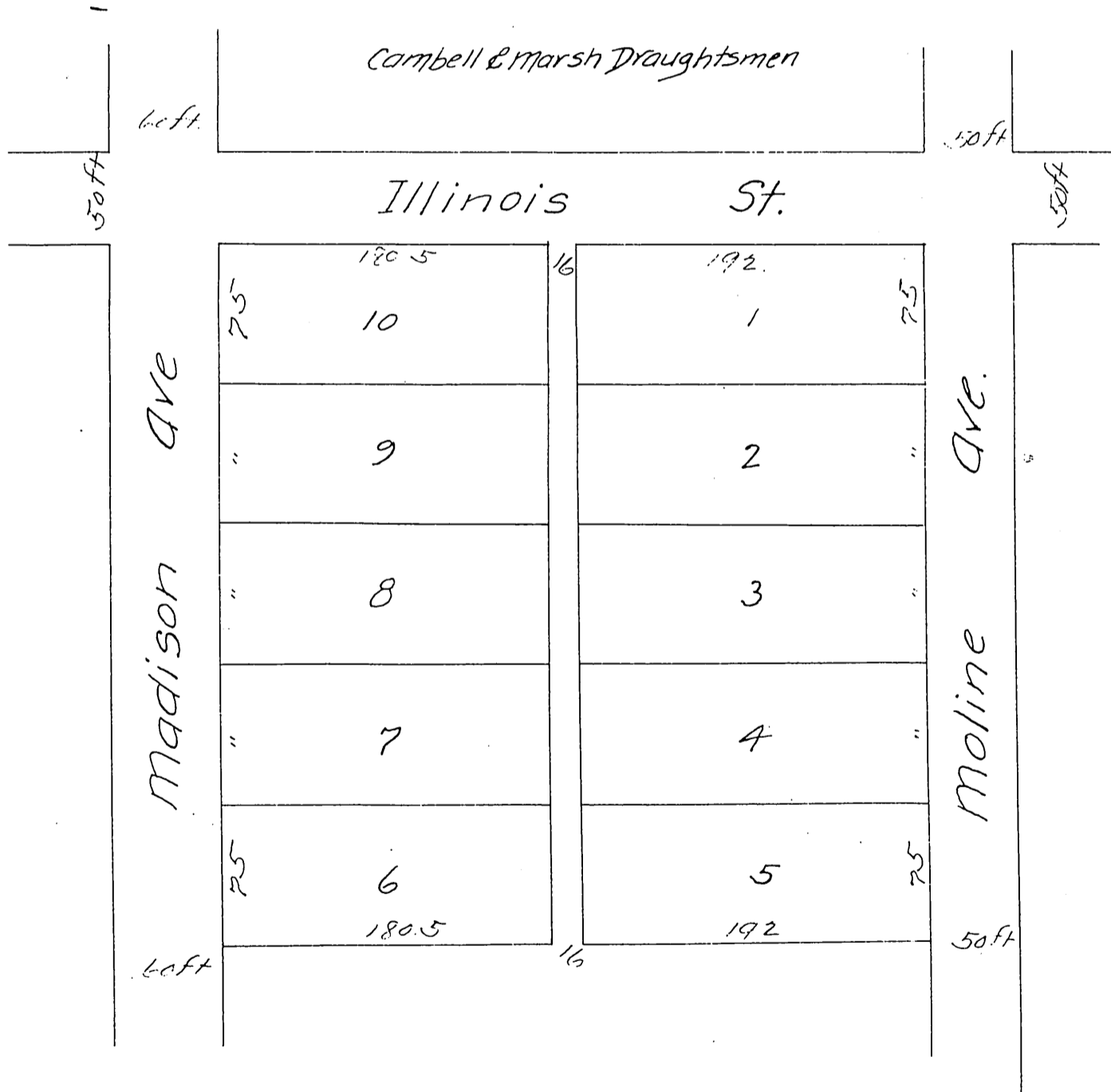

A full, true and correct copy of the original.
 (reduced to the scale of 80 feet to one inch)
 recorded September 7, 1887 at 10:45 A.M. at
 request of J.C. Rust
 Frank A. Gibson County Recorder.
 By George Bugbee Deputy.