



Alessandro Tract.

Being a subdivision of the Goodner & O'Melveny Tract.

Surveyed by E.R. Shrader University of Southern California.

Scale 130.5 ft to the inch.

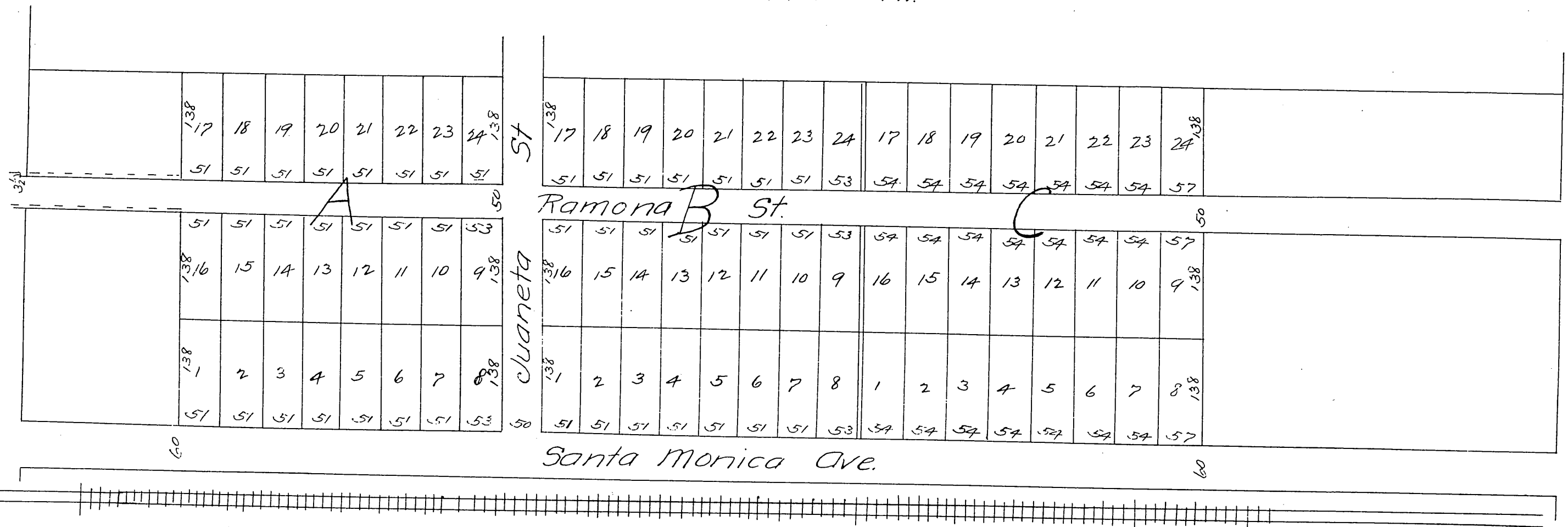

a full, true and correct copy of the original
 Recorded September 10, 1887, at 9²⁵ a.m. at
 request of Hiram Sinsabaugh.
 Frank Gibson county Recorder.
 By George Bugbee Deputy.