

MAP
OF
Packard's Addition
to the Packard Vineyard Tract.
Pomona, Cal.

Surveyed in July 1887 by H E Stoddard Surveyor.
Scale 50 ft to 1 inch.

Note.
All areas and distances are computed to
the center of the streets except on Town Ave.
rue (which are to the side)
Streets are 60 feet wide 10 feet on each side
of streets being reserved for sidewalks
leaving 40 feet for roadway.

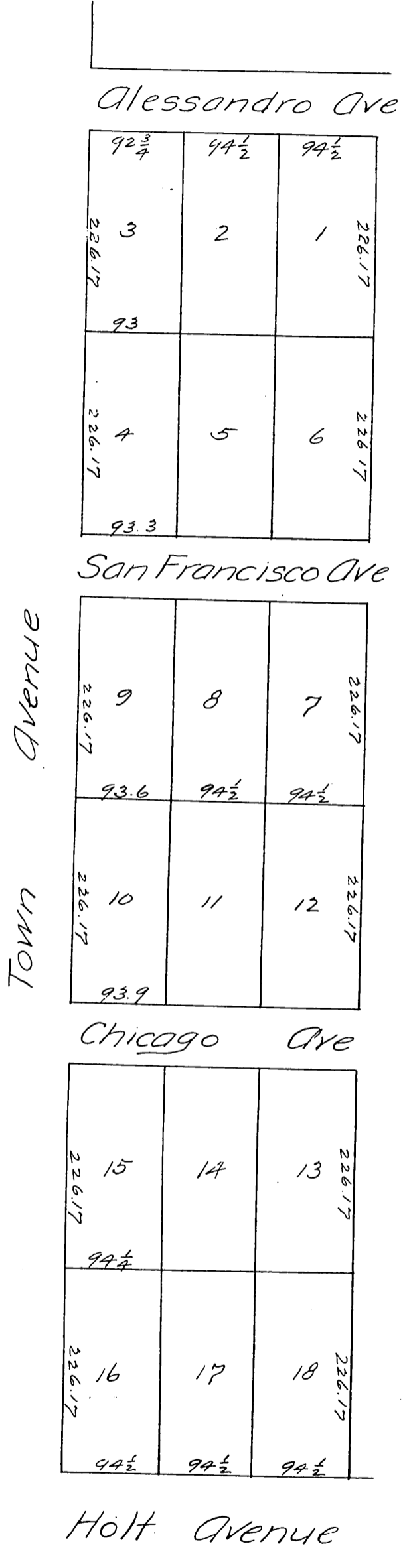

Alessandro Ave

92 $\frac{3}{4}$	94 $\frac{1}{2}$	94 $\frac{1}{2}$
226.17 3	2	1 226.17
93		
226.17 4	5	6 226.17
93.3		

San Francisco Ave

226.17 9	8	7 226.17
93.6	94 $\frac{1}{2}$	94 $\frac{1}{2}$
226.17 10	11	12 226.17
93.9		

Chicago Ave

226.17 15	14	13 226.17
94 $\frac{1}{4}$		
226.17 16	17	18 226.17
94 $\frac{1}{2}$	94 $\frac{1}{2}$	94 $\frac{1}{2}$

Holt Avenue

a full, true and correct copy of the original.
(Reduced to the scale of 120 feet to one inch.)
recorded September 12, 1887 at 54 min Past
9 a.m. at request of John E. Packard
Frank A Gibson County Recorder.
By George W. Bugie Deputy.