

MAP
 OF
 J. M. Howard's Subdivision
 of the Cromer Tract,
 POMONA, CAL.
 Surveyed in Sept 1887 by H. E. Stoddard C.E.
 Scale 50 ft to 1 inch.

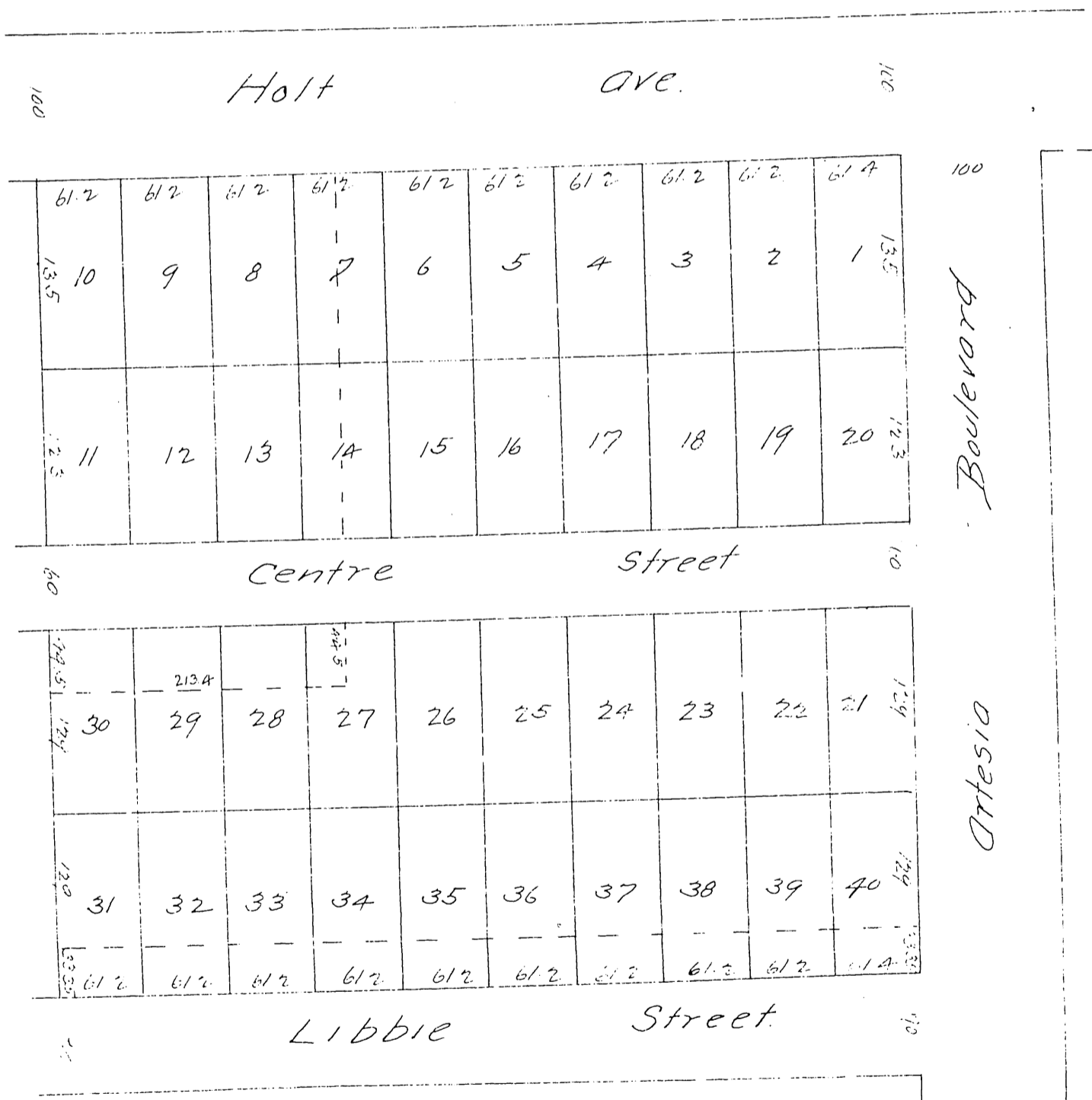

A full true and correct copy of the original (reduced
 to 100 feet to one inch) recorded Sept 24th 1887
 at 11 270. m, at request of Los Angeles Land Bureau.
 Frank A. Gibson County Recorder.
 By George Bugbee Deputy