



MAP

OF THE

Daman & Millard Tract

Being Shafer and Daman & Millard's Subdivision
of the Southwesterly 13 acres of Lot 6, Block 1
Hancock's Survey of the City of Los Angeles, Cal.

Surveyed Aug 1887 by Sheperd & Harris

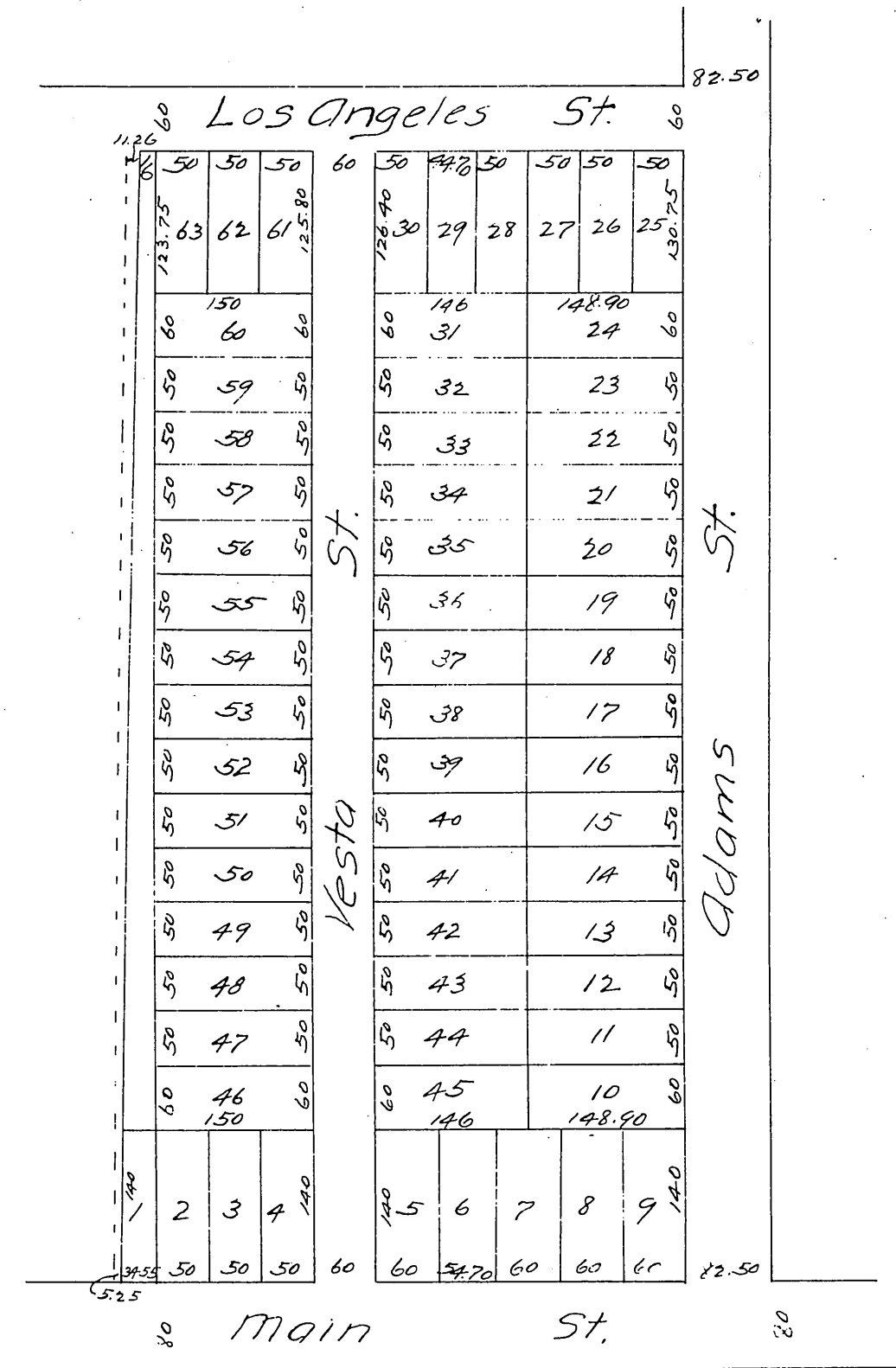

A full, true and correct copy of the original,
(reduced to the scale of 150 feet to one inch)
recorded Sept 16, 1887 at 10 min past 11. A.M.
at request of A.O. Daman.

Frank Q. Gibson County Recorder.
By George Bugbee, Deputy.