

MAP
 OF
 Kessler Stanchfield & Cos Subdivision
 of the North 5 acres of Block 223,
 POMONA TRACT.

Surveyed in Aug 1887
 BY
 H. E. Stoddard C.E.

Scale 50 ft to 1 inch

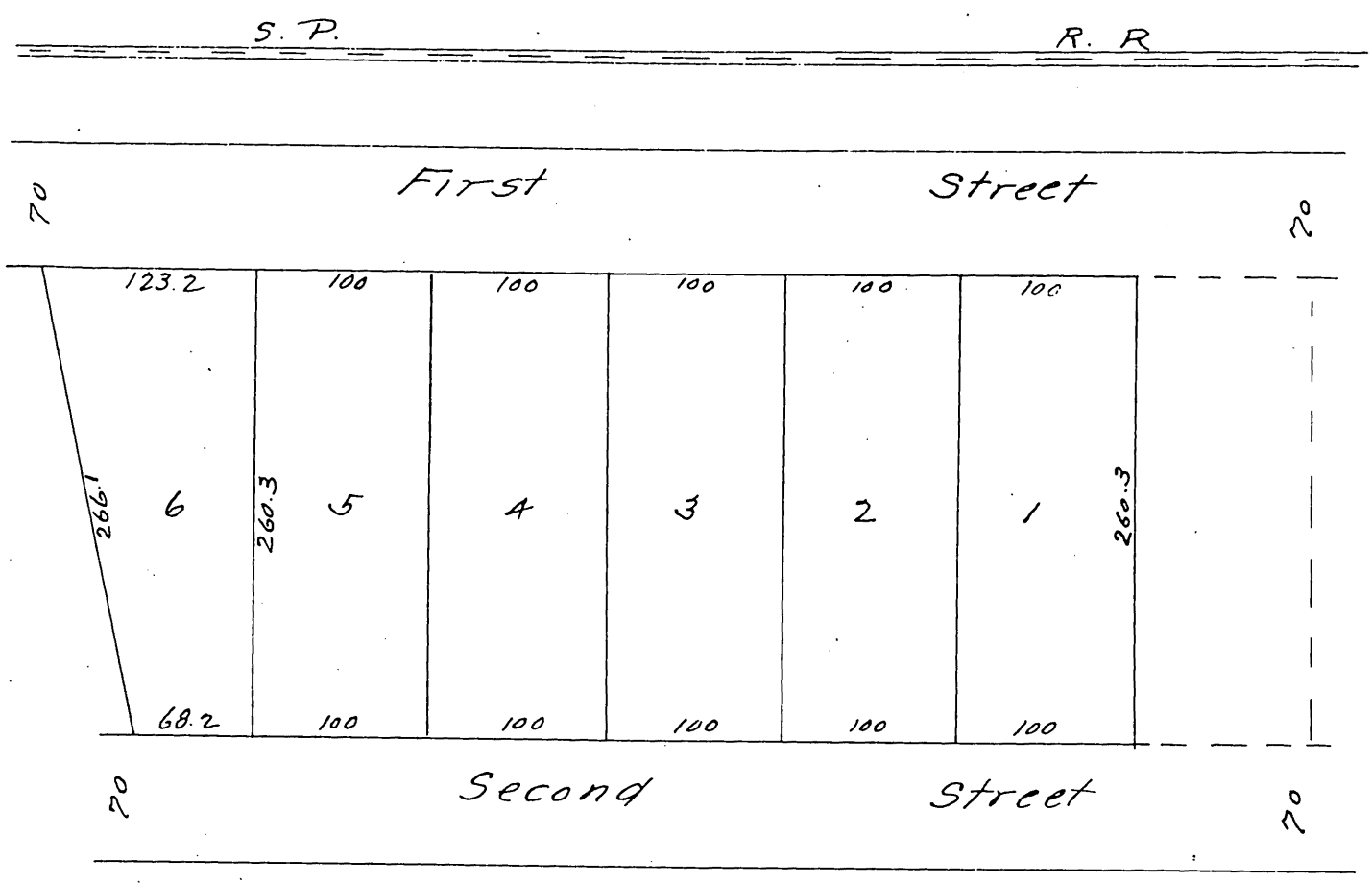

A full true and correct copy of the original (reduced to the scale of 100 feet to one inch) recorded Sept 21st 1887 at 4:12 P.M. at request of Chas Mahon.

Frank A Gibson County Recorder.
 By George D Bugbee Deputy.