

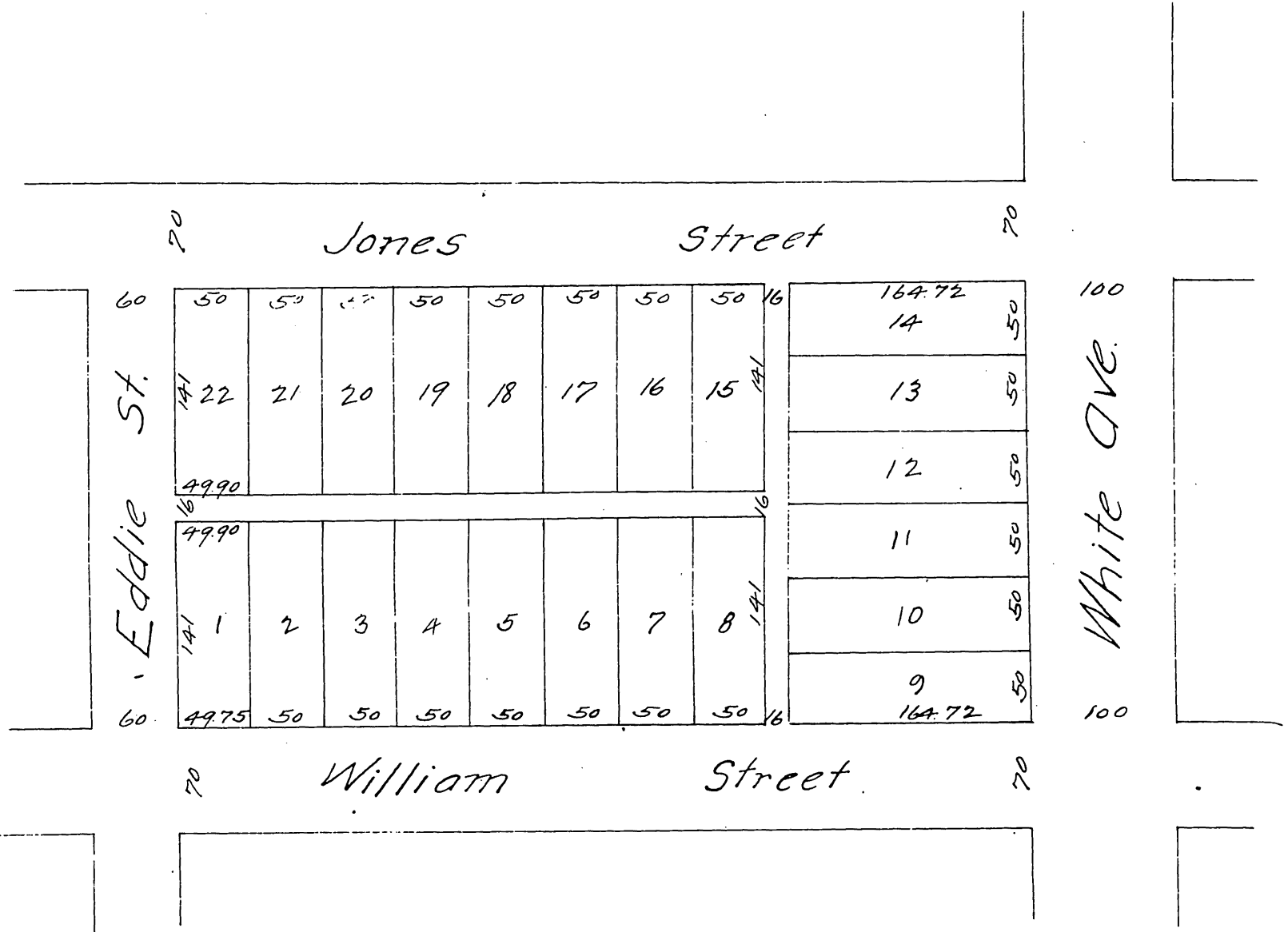

MAP
 OF
 William O'Connor's Subdivision
 of Lots 142, Block 182,
 TOWN OF POMONA, CALIFORNIA.
 J. S. Taylor & Co Surveyors.
 Augt 1887
 Scale 50ft to 1 inch.



A full true and correct copy of the original. (Reduced to the
 scale of 100 feet to one inch recorded September 23rd 1887
 at 4:1 P.M. at request of J.S.T. Taylor & Co,

Frank O Gibson Co Recorder.
 By George Bugbee Deputy.