

MAP
OF
S. N. Androu's Subdivision
of the Bieley Tract.
POMONA, CAL.

Surveyed in Sept, 1887 by H. E. Stoddard, C.E.

Scale 50 ft to 1 inch.

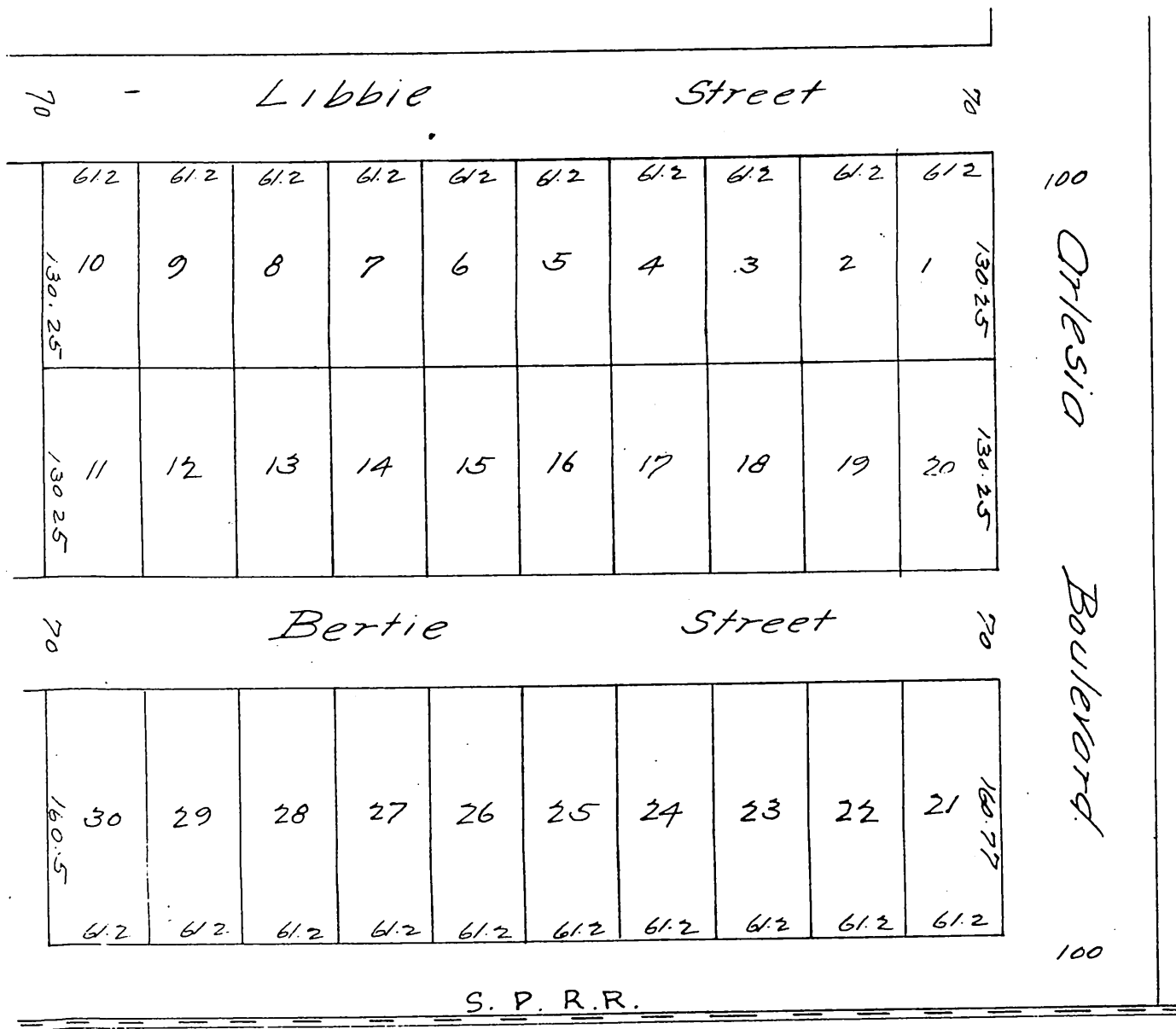

A full true and correct copy of the original (reduced to the scale of 100 feet to one inch) recorded September 24th 1887 at 28 min past 11 A. M. at request of Los Angeles Land Bureau.
Frank A. Gibson Co Recorder.
By George Bugbee Deputy.