

# Hoyt Tract

BEING A SUBDIVISION

of the

S<sup>1</sup>/<sub>2</sub> OF THE N.E. <sup>1</sup>/<sub>4</sub> OF THE SE <sup>1</sup>/<sub>4</sub> OF THE NE <sup>1</sup>/<sub>4</sub> OF SEC.  
1 T P 2 S R 14 W. S. B. M.

LOS ANGELES, CALIFORNIA

Surveyed by J. S. McDonald C.E. MONROVIA  
Scale 50 ft. = 1 inch.

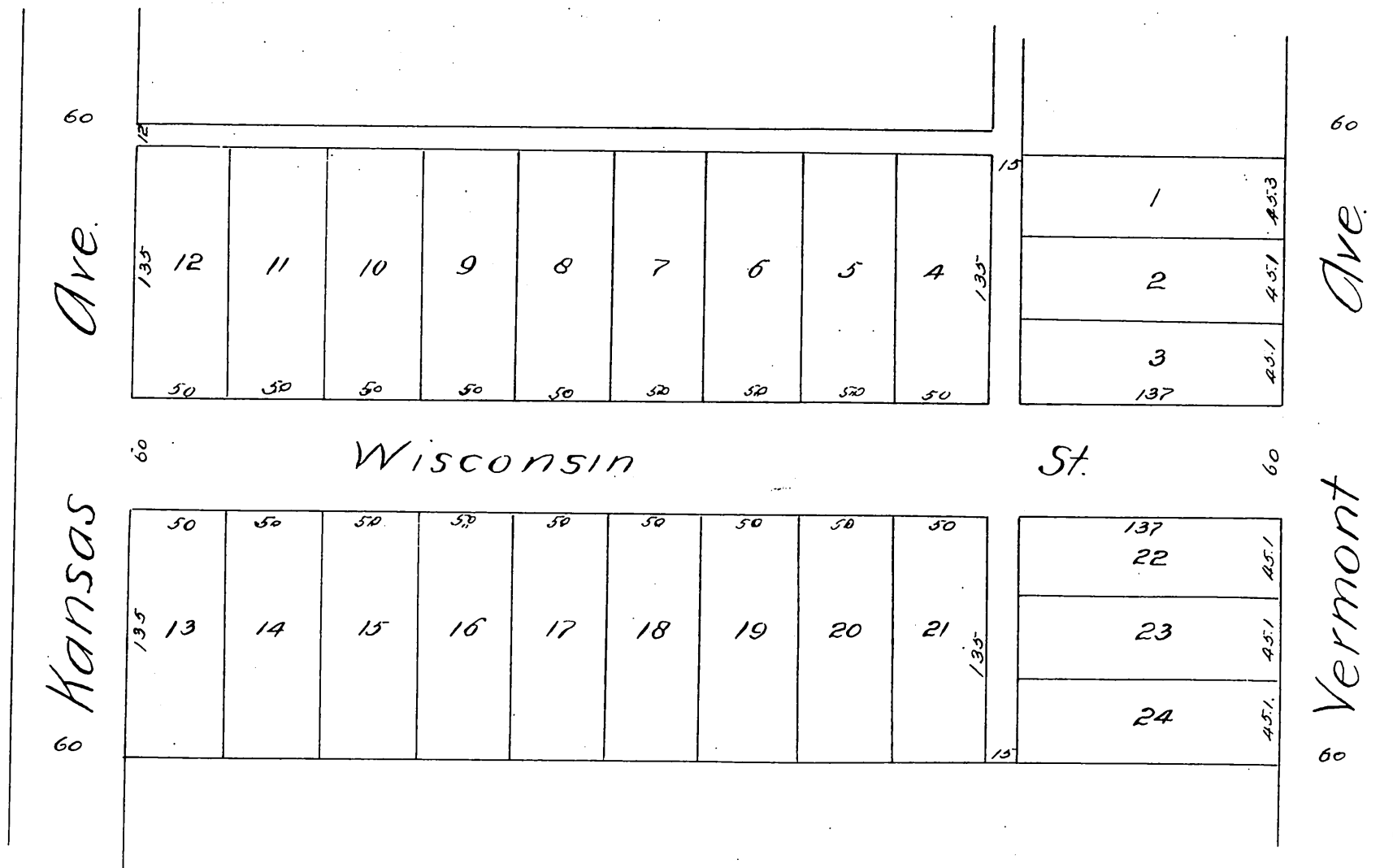

A full, true and correct copy of the original  
reduced to a scale of 80 ft. to the inch, record-  
ed Sept 29, 1887 at 10.090 M at request of  
H. B. Pinney  
Frank O. Gibson, County Recorder.  
By George Bugbee Deputy.