

MAP
of replat of a portion of
J.E. Packard's

VINEYARD TRACT
POMONA, CAL

Surveyed July 1887 by H.E. Stoddard, C.E.
Scale 100ft to 1 inch.

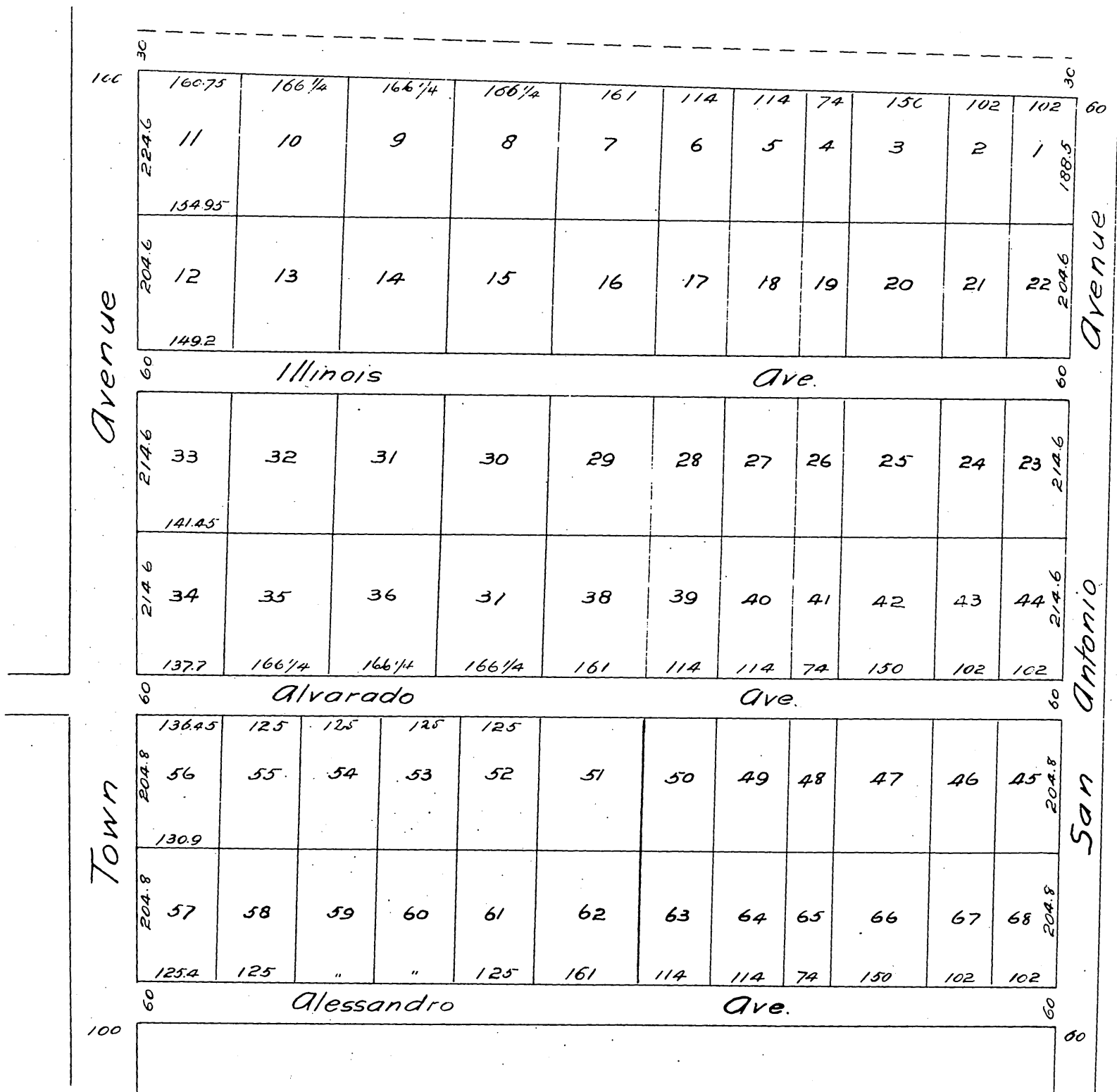

A full, true and correct copy of the original, reduced to a scale of 200 feet to the inch, recorded Sept. 29 1887 at 11.24 A.M. at request of J.E. Packard.

Frank A. Gibson, County Recorder.
By George Laugbee, Deputy.