

*Map*  
OF  
**HARTS SUBDIVISION**  
**PASADENA**  
**LOS ANGELES CO. CAL**  
Surreyed 1887 by Baldwin Jessup & Co  
SCALE 100 FT TO INCH.

Campbell & Marsh  
Draughtsmen

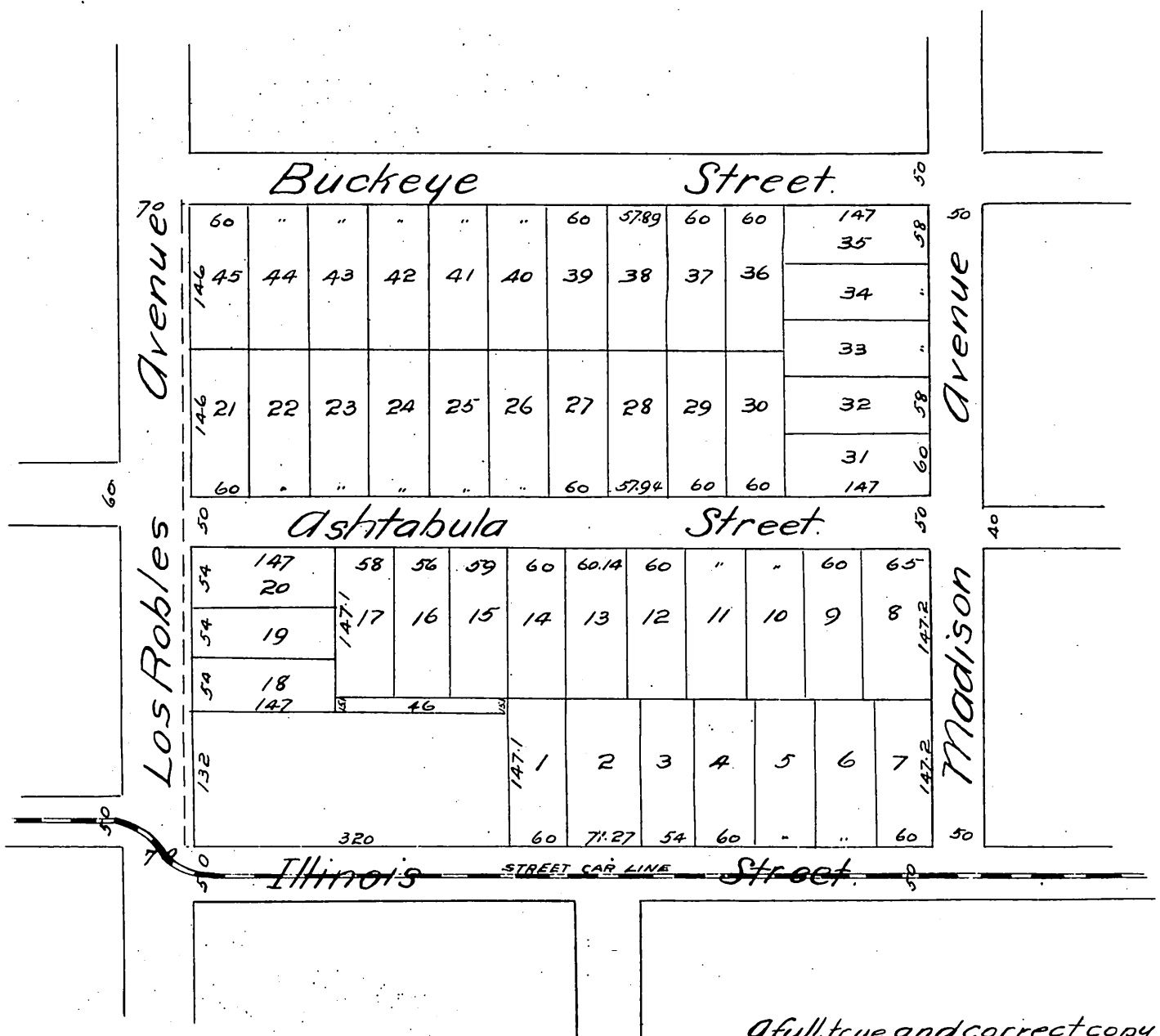

A full, true and correct copy of the original, reduced to  $\frac{3}{8}$  size, recorded Oct 5, 1887 at 11.10 A.M. at request of E. Hart.  
Frank O. Gibson County Recorder.  
By George Bugbee Deputy.