

Subdivision
of Blocks 10 & 11
in the town of
Santa Ana East

Commence 30' S of a point 45' E of the N.W. cor. of the above mentioned
Block 10 for the N.W. cor. of Lot 1

Surveyed and mapped by S.H. Finley.
MAR. 1887.

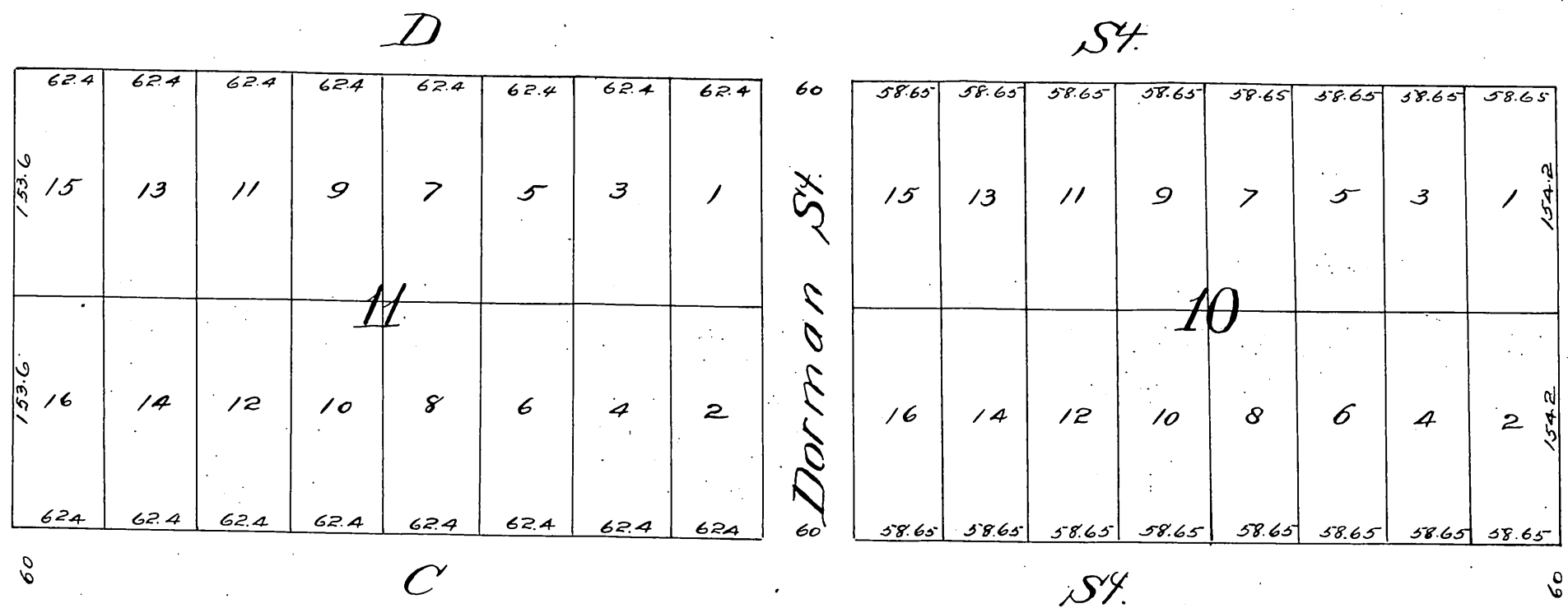

A full, true and correct copy of the original recorded
October 13, 1887 at 9³² AM. at request of Geo. E. Freeman.
Frank H. Gibson Co. Recorder
by George B. Ugebe. Deputy.