

Map
 OF
F. J. Stetson's Subdivision
 of part of the
A. B. Grogan Tract,
 consisting of 13.07 acres on Colorado St & Hill Ave.
PASADENA,
 Surveyed 1887 by Baldwin Jessup & Co.
 Scale 100ft to 1 inch
Gambell & Nash, Draftsmen.

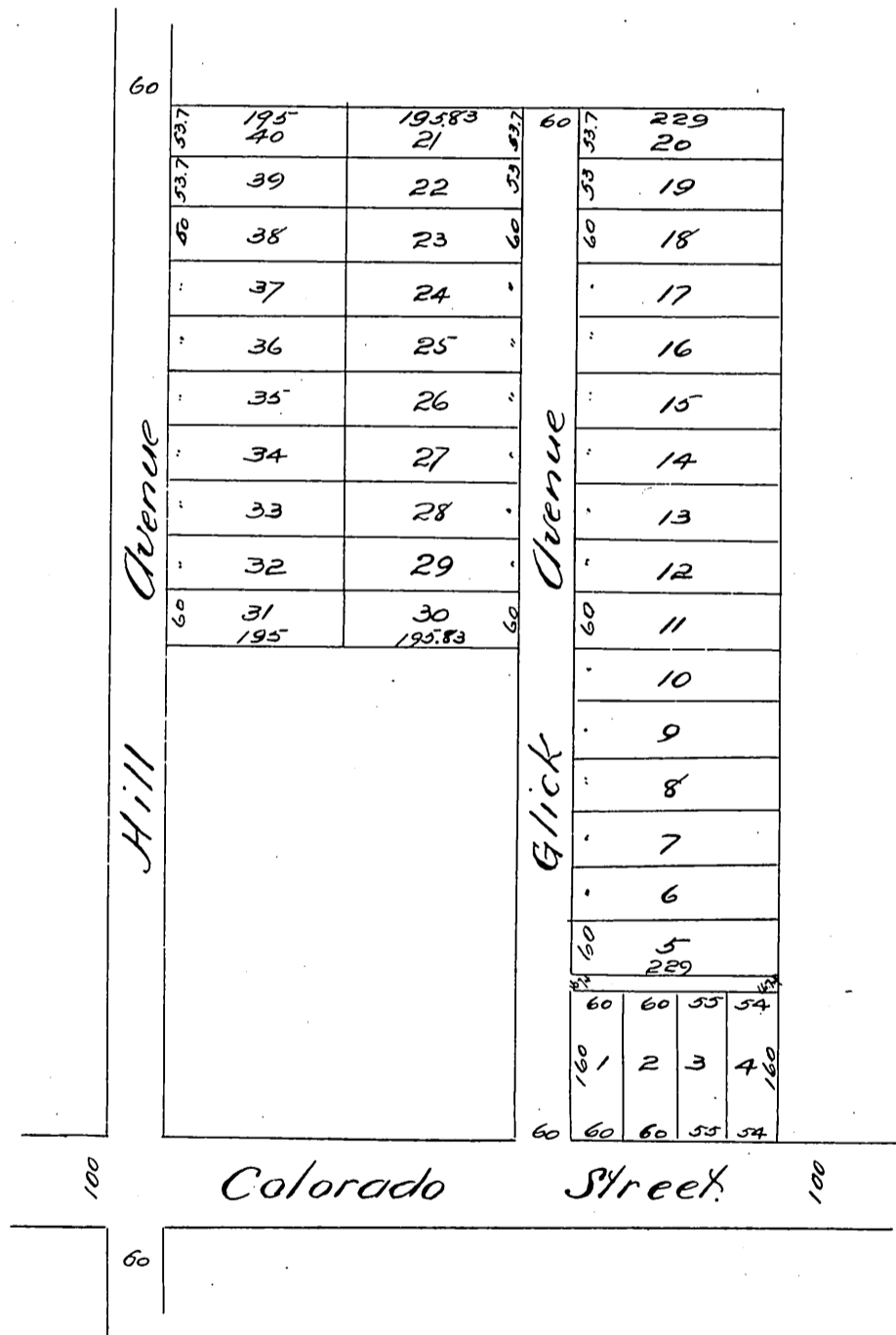

A full true and correct copy of the original (reduced to
 the scale of 200 feet to one inch) recorded Oct 13, 1887.
 at 55 min past 11 A.M. at request of F. J. Stetson.
 Frank J. Gibson County Recorder.
 By George Bugbee Deputy.