

J. W. Mc Bride & Co's Subdivision

of the North 1/2 of Block 183,
of the town of

POMONA, Los Angeles County, California

Jas. T. Taylor & Co. Surveyors.

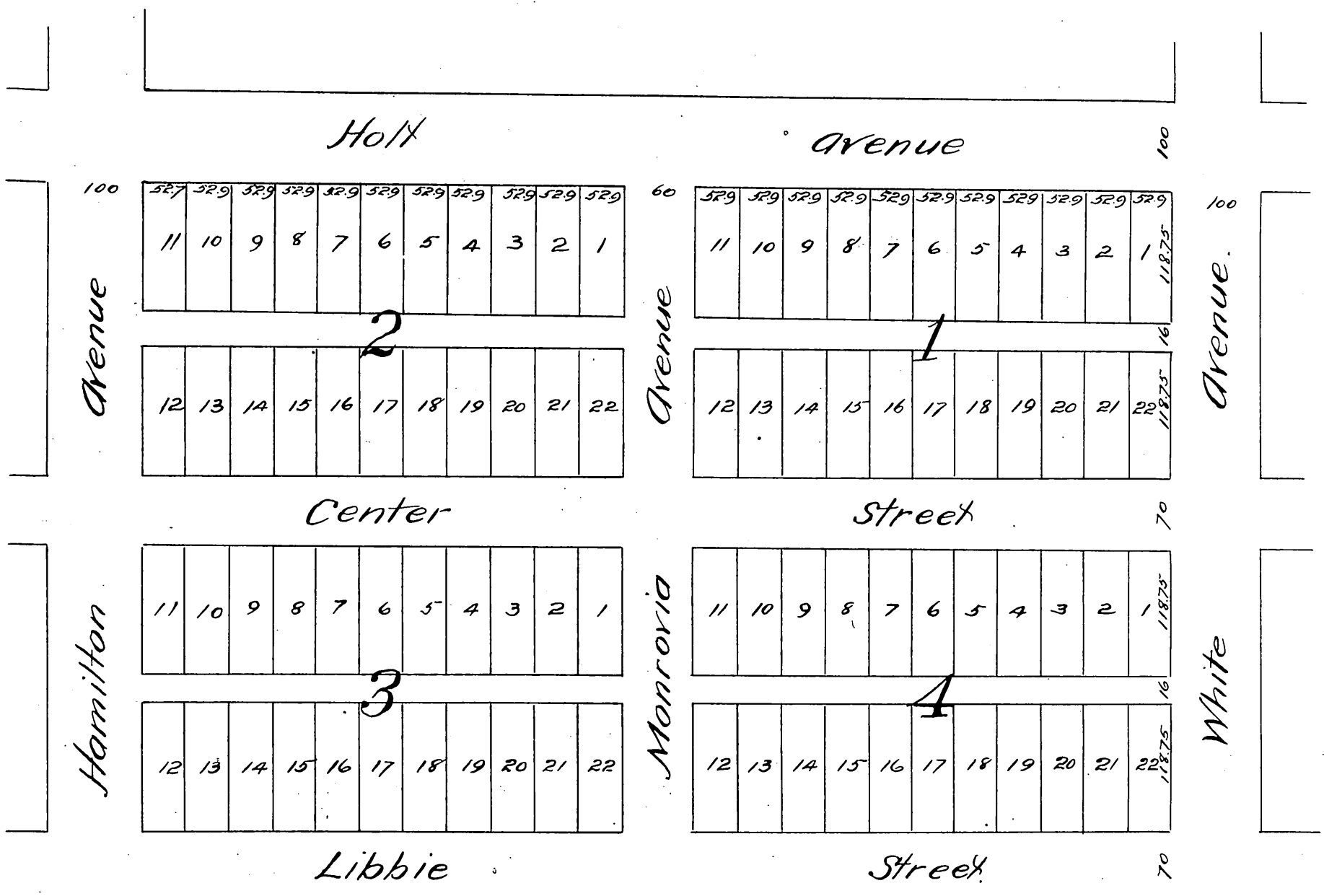

A full true and correct copy of the original (reduced one half)
 recorded Oct 17 1887 at 10⁵³ A.M. at request of A. Crabb.
 Frank A. Gibson County Recorder.
 by George Rugbee Deputy.