

MAP OF Sedalia Villa Tract Los Angeles, Cal.

Surveyed Oct. 1887 by H. J. Stevenson.

Scale 100 feet to one inch.

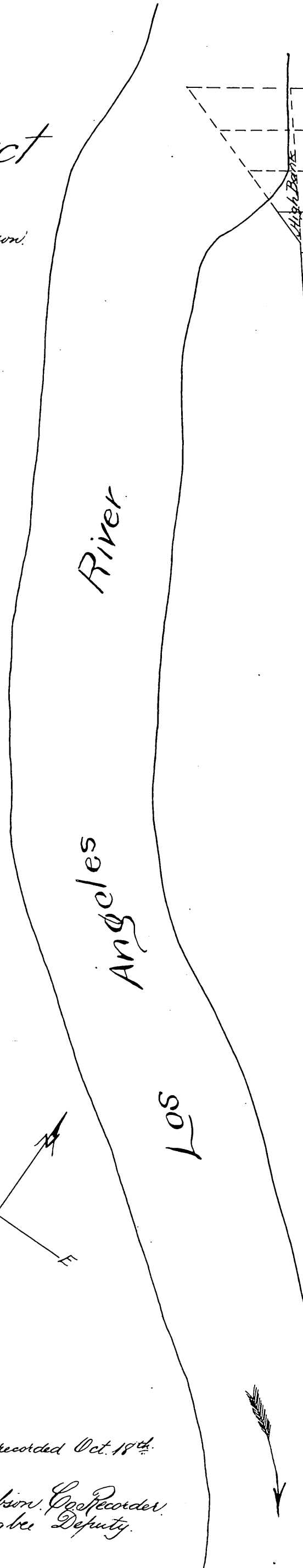

	343.2	
	1	40
	312.5	
	2	40
	281.7	
	3	40
	250.9	
	4	40
	227	
	5	40
	223.8	
	6	40
	220.7	
	7	40
	217.6	
	8	40
	214.4	
LOT 3	9	40
	211.3	
	10	40
	208.1	
	11	40
	205	
	12	40
	201.9	
	13	40
	198.7	
	14	40
	195.6	
	15	40
	192.4	
	16	40
	189.3	
	17	40
	190.1	
	18	40
	190.9	
	19	40
	191.7	
	20	40
	192.5	
	21	40
	193.3	
	22	40
	194.1	
	23	40
	194.9	
	24	40
	195.7	
	25	40
	196.5	
	26	40
	197.3	
LOT 4	27	40
	198.1	
	28	40
	198.9	
	29	40
	199.7	
	30	40
	200.5	
	31	40
	201.3	
	32	40
	202.1	
	33	40
	202.9	
	34	40
	203.7	
	35	43.7
	204.6	

LOT 3

LOT 4

Highland View Tract
Hunter

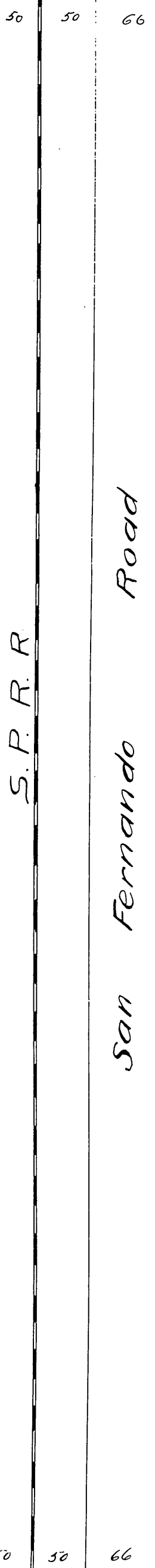

A full true and correct copy of the original recorded Oct. 18th.
1887 at 2:16 P.M. at request of H. E. Curry

Frank A. Gibson, Co. Recorder.
by George Hughes Deputy.