

# Map of

## Lathrop Tract

The real property described in deed from Haddock  
to H. A. Parmer recorded in Book 276 of Deeds page 73  
of records of Los Angeles Co Cal

Pomona Cal

Jas T. Taylor & Co Surveyors August 1887  
Scale 50ft = 1 inch

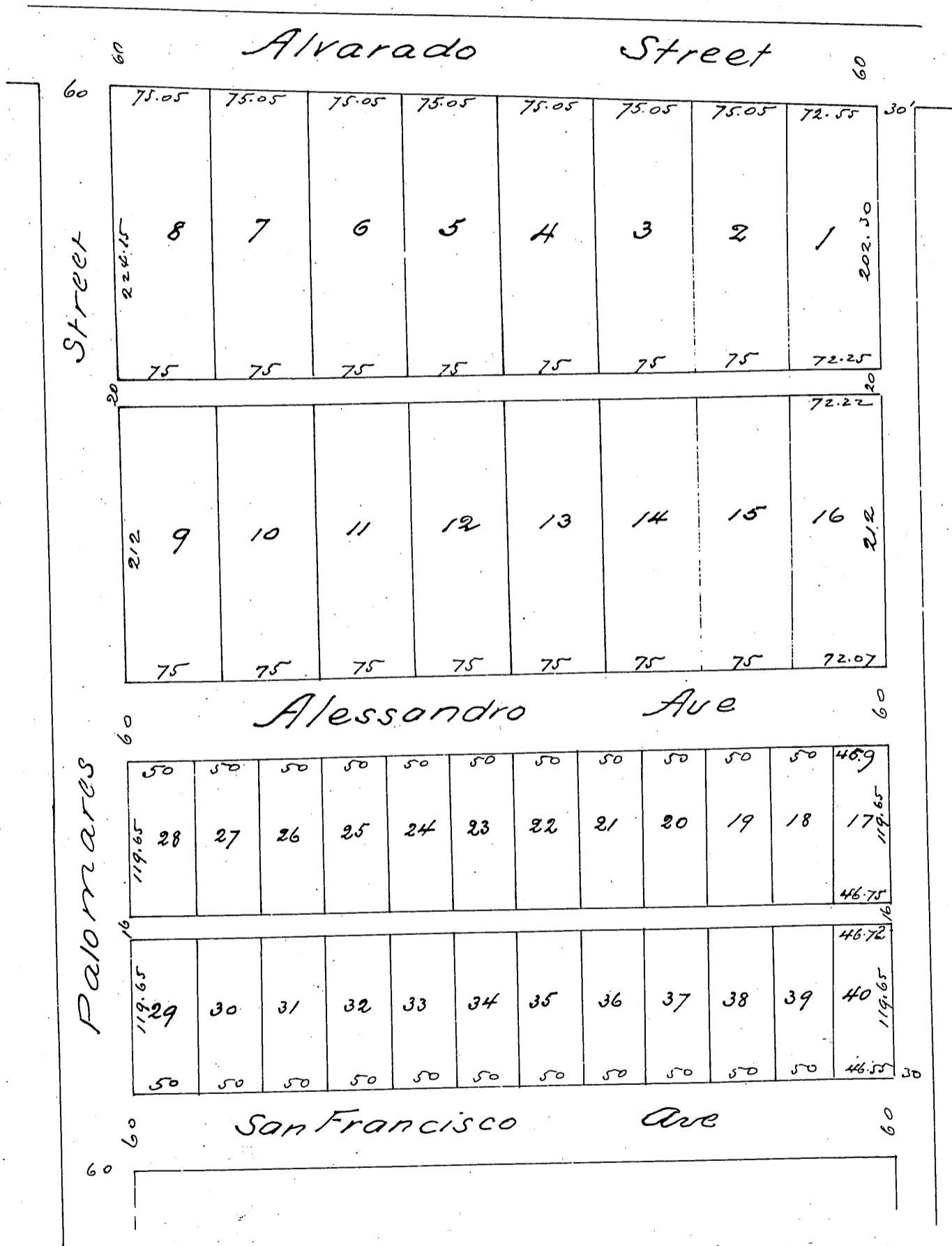

A full, true and correct copy of the original (reduced  
to scale of 100 feet to one inch) recorded Oct 20<sup>th</sup> 1887 at  
3<sup>57</sup> P.M. at request of Lathrop and Son  
Frank A. Gibson Co Recorder  
by George Bugbee Deputy