

Map OF Barrow's Addition

to the
City of Los Angeles California
Surveyed October 1887 by H.J. Steverson
Scale 200ft to one inch

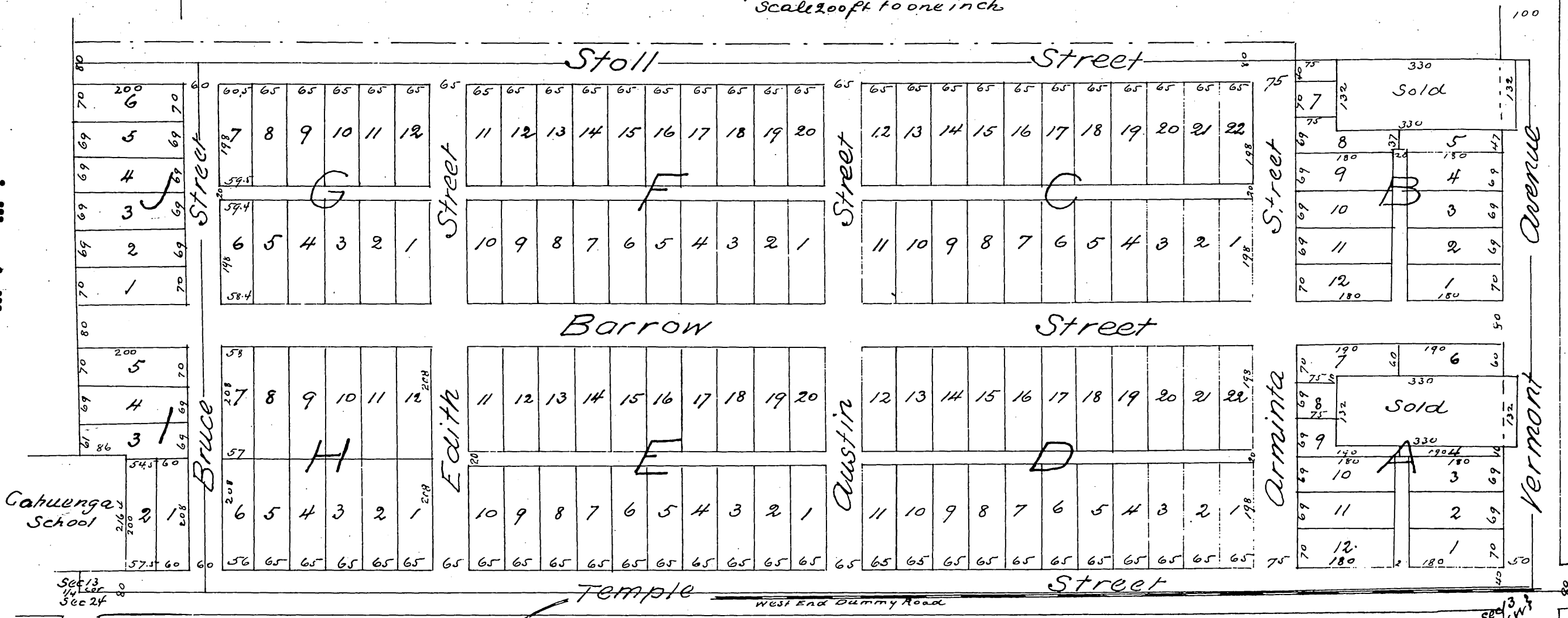

A full true and correct copy of the original recorded Oct 2nd 1887
at 4 min past 3 PM at request of R. McGurvie
Frank A. Gibson County Recorder
By George Bugbee Deputy

SE. Cor. Sec 3
T. 1 S. R. 10 W. 100