

# Map of the Corson Tract

Being a Subdivision of Lots 6 & 7 of the Linden Place of the  
Grogan Tract Rancho San Pasqual  
Pasadena Cal

Surveyed by Mount & Drummond Oct. 1887  
Scale 480 ft to one inch

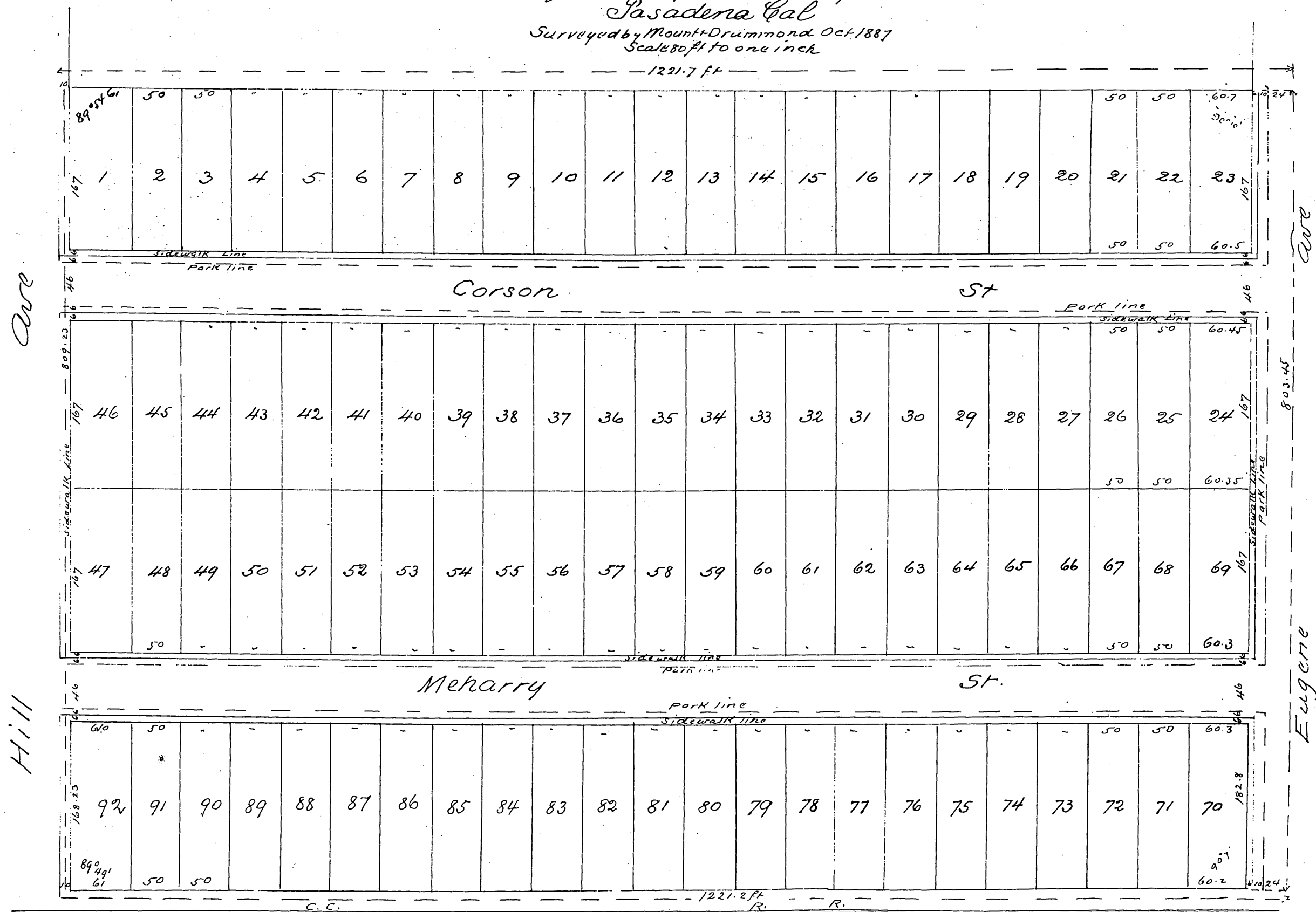

A full true and correct copy of the original (reduced to 100 ft to one inch)  
recorded Oct. 22<sup>nd</sup> 1887 at 4:49 P.M. at request of J. Blankenhorn  
by Frank A. Gibson - Co. Recorder  
by George Bugbee Deputy