

Plat
 OF
 Sepulveda's Subdivision
 of Block 8
 Town of San Pedro
 Scale 100 feet = 1 inch

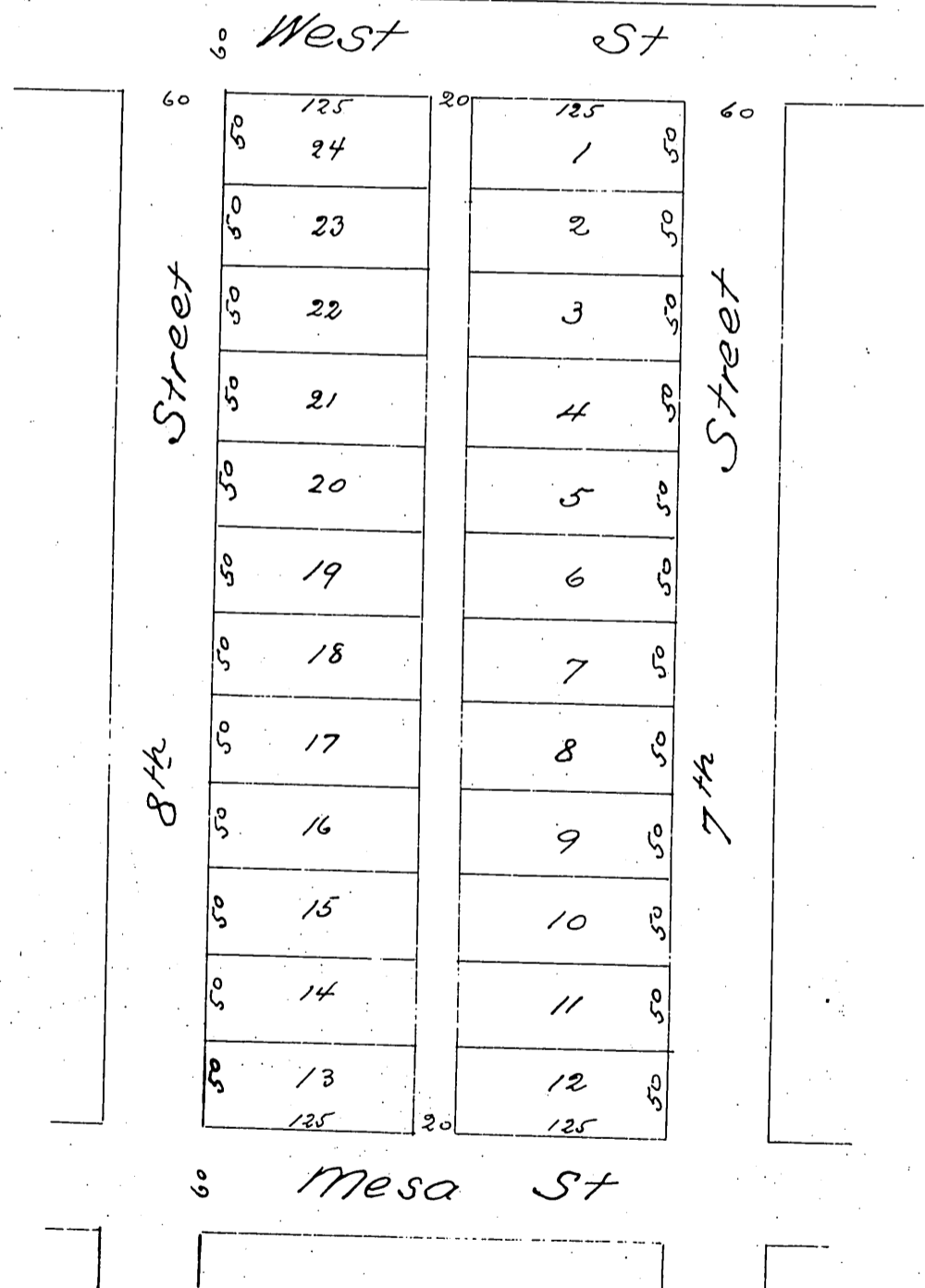

A full true and correct copy of the original recorded
 Oct 25th 1887 at 8 AM at request of PR Sepulveda
 Frank A Gibson Co Recorder
 by George Bugbee Deputy