

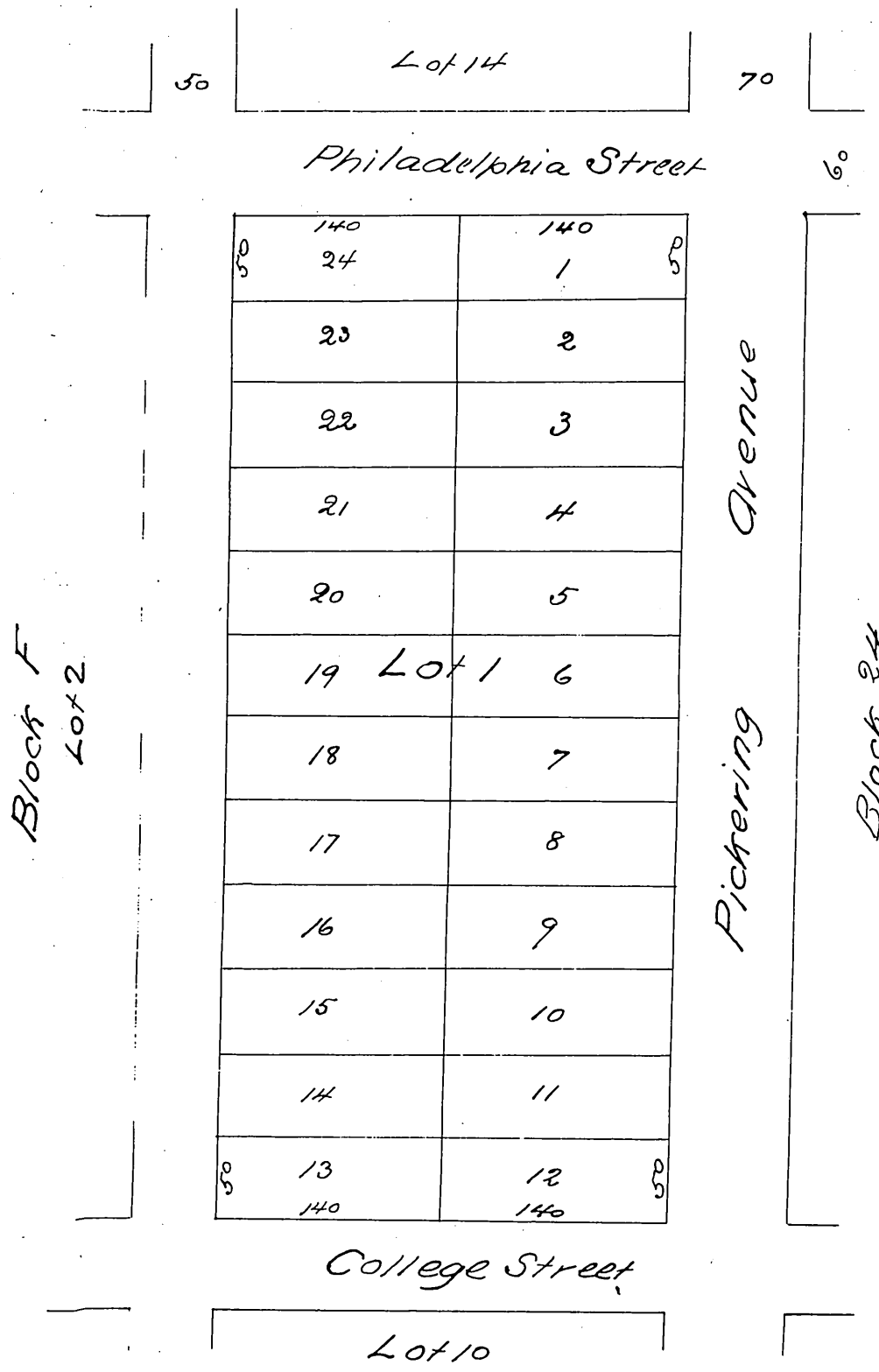

Plat of  
 Subdivision of Lot 1 Blk. F  
 of the  
 Pickering Land & Water Company's Subdivision  
 of the  
 John M. Thomas Tract  
 in Los Angeles County California  
 made at the request of A. T. Patton July 27<sup>th</sup> 1887  
 Scale 100 feet to one inch

Patton's Subdivision  
 of Lot 1. Block F  
 Whittier, Cal



A full true and correct copy of the original recorded Oct 28<sup>th</sup> 1887  
 at 2 min past 3 P.M. at request of J.T. Anderson  
 Frank A. Gibson County Recorder  
 by George Rughley Deputy