

Woodworth & Platt's Subdivision
of a part of
Block J. Painter + Ball's Tract
Pasadena
Los Angeles Co Cal
Surveyed by Jessup & Reece Oct 1887
Scale 80 feet to 1 inch

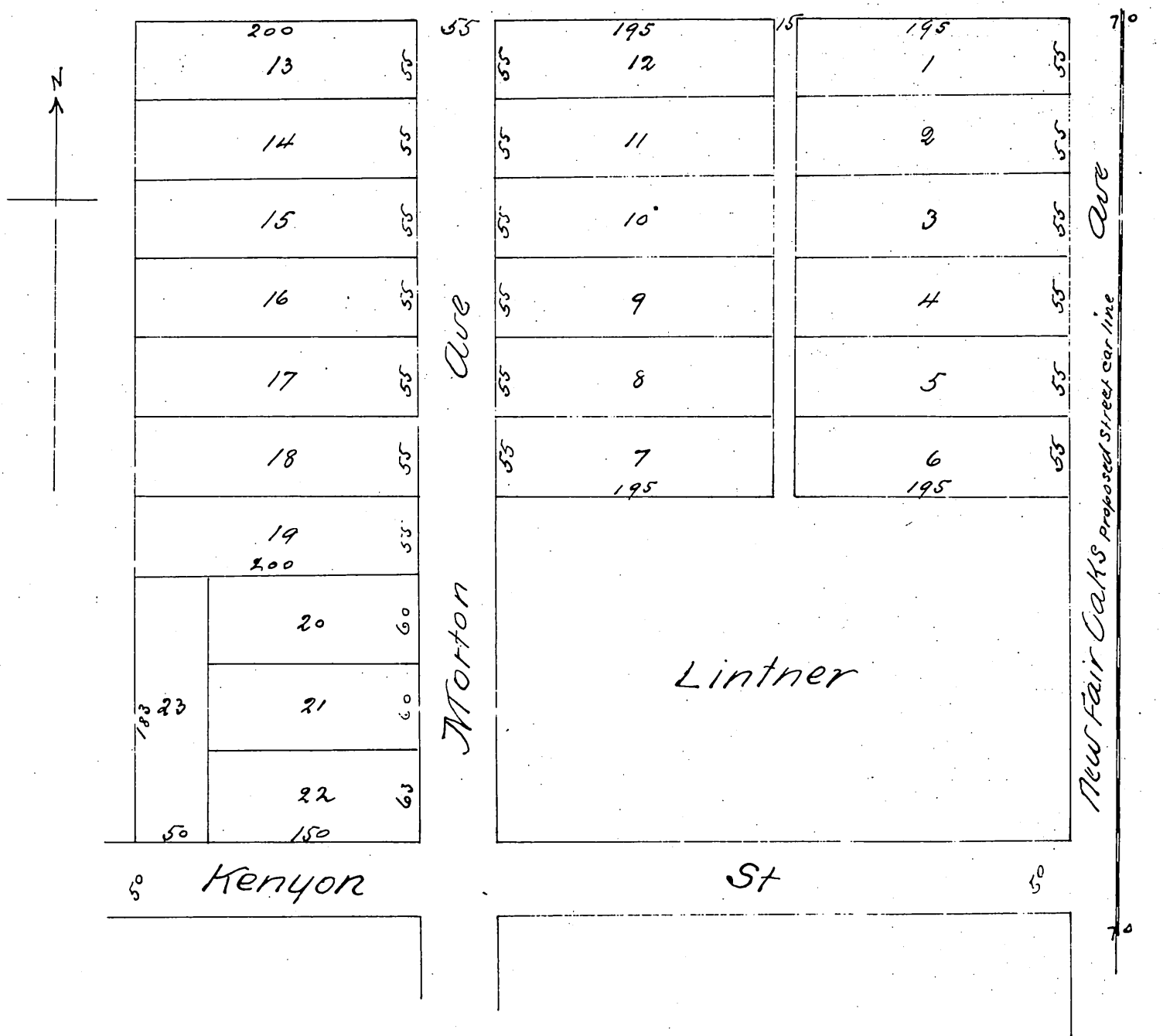

A full true and correct copy of the original (reduced to the scale of 100 feet to one inch) recorded Oct 29th 1887 at 6 min past 4 P.M. at request of J. H. Woodworth.

Frank A. Gibson & Co. Recorder
by Wm E. Johnston Deputy