



Map

OF THE

Subdivision of Blocks A and B

in the

Yorba & Paige Tract

Reference is hereby made to Book 24 page 56 Miscellaneous Records of Los Angeles County

Scale 3/4 in = 100 ft

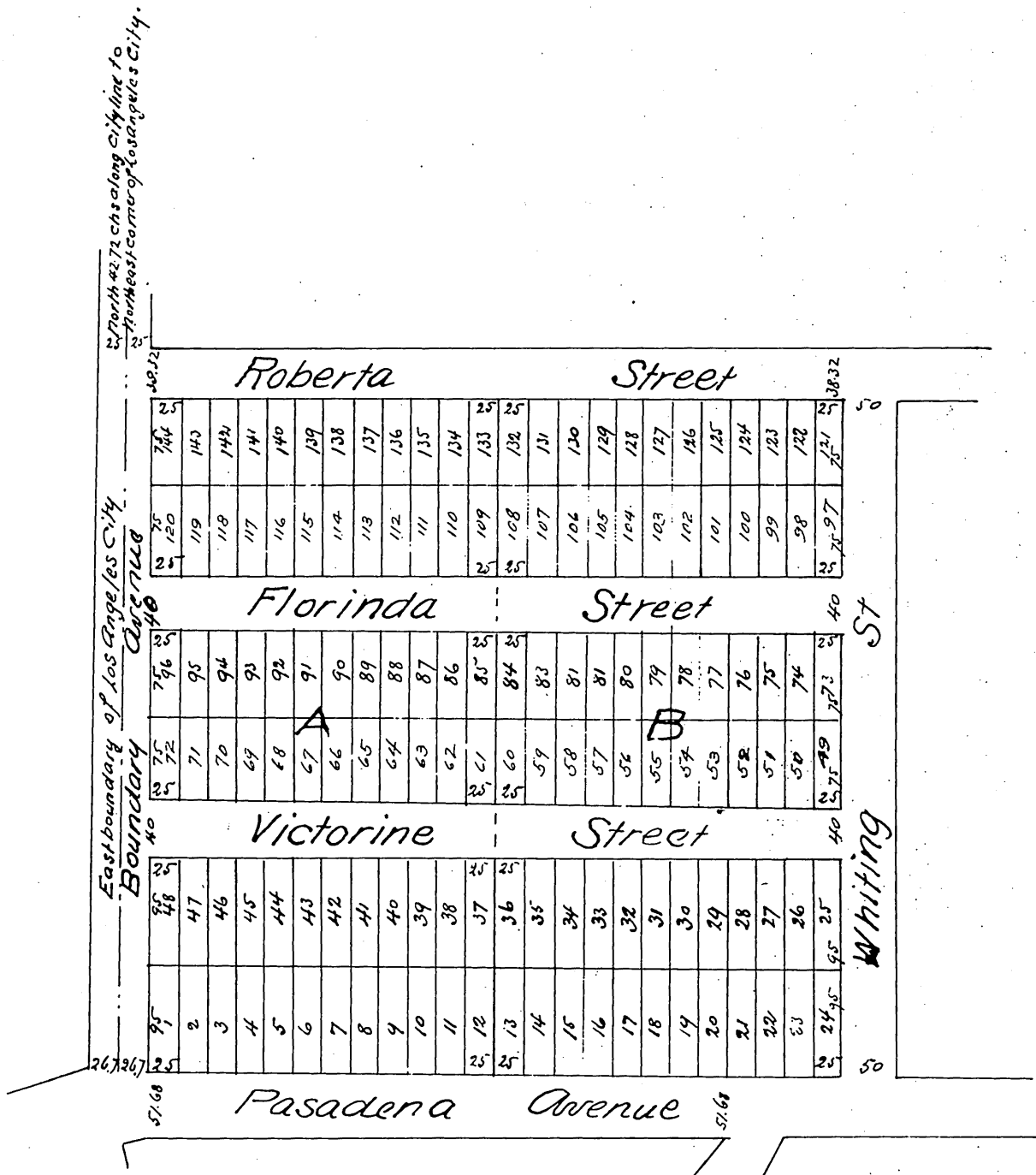

A full true and correct copy of the original recorded Nov. 3rd 1887 at 2⁴⁰ P.M. at request of J.F. Yorba

Frank A. Gibson County Recorder
by Wm. E. Johnston Deputy