

Map OF Cumming's AND Moons Addition TO Fairview

Being Lots 37, 38, 47, 48 of the Fairview Tract.
Scale 100 ft = 1 inch.

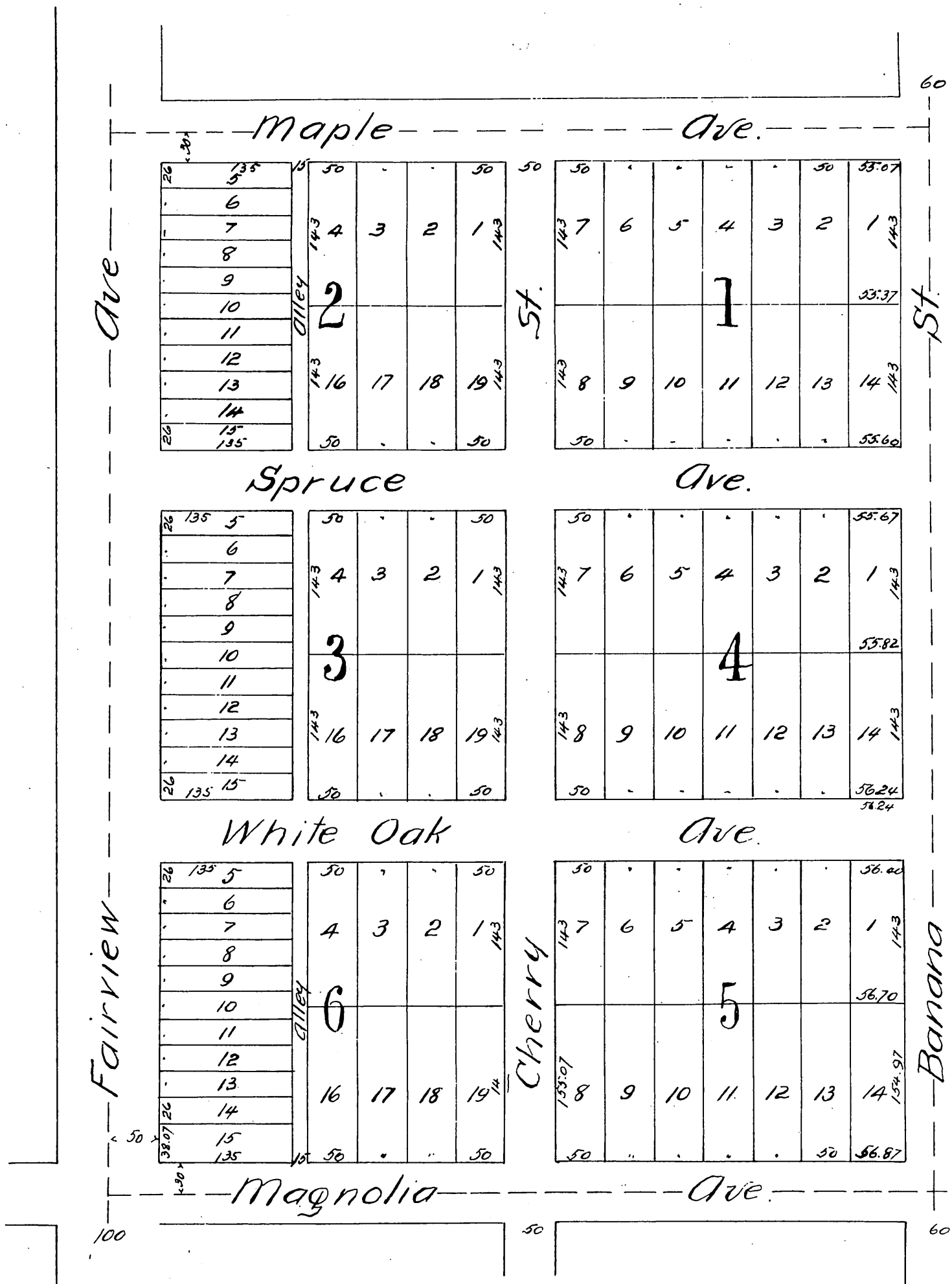

A full, true and correct copy of the original
(reduced to the scale of 120 feet to one inch)
recorded Nov 17, 1887 at 14 min. past 10 A.M.
at request of Cumming's & Moons.

Frank A. Gibson County Recorder.
By George Langbe. Deputy.