

# Richards AND Morrow's Addition

TO

## Whittier

Being a subdivision of Lot 7 Block D of the Pickering Land and Water Company's Subdivision of the John M. Thomas Ranch Los Angeles County Cal.

Surveyed Dec 1887 by Jessup, Peerce & Clampitt Surveyors.  
Scale 70 feet to 1 inch.

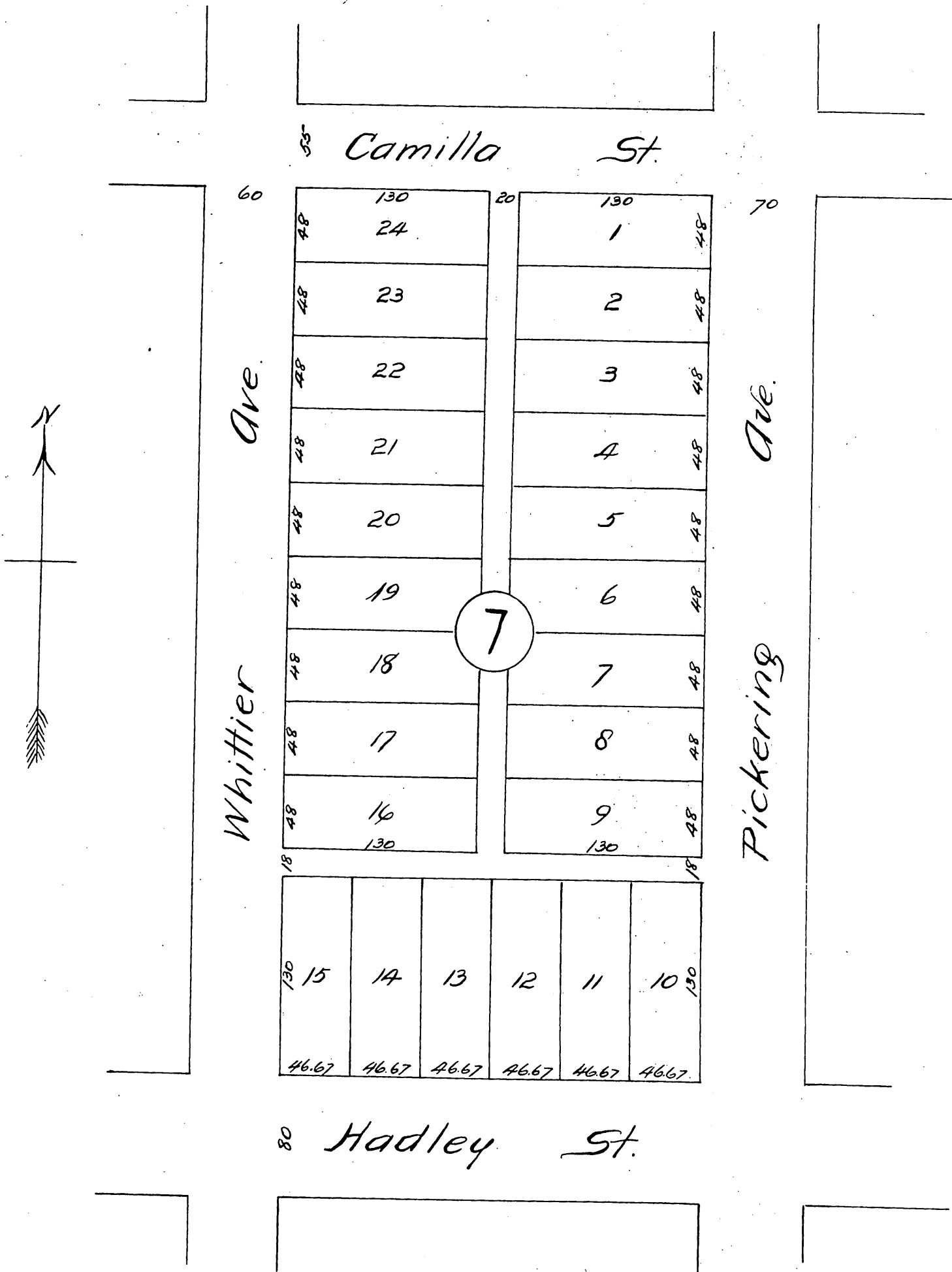

A full, true and correct copy of the original (reduced to the scale of 80 feet to one inch) recorded Jan. 3, 1888 at 36. min. past 8 O'Clock at request of O.G. Richards.

Frank A. Gibson County Recorder.  
By George Bugbee Deputy.