



Hutchinson's Subdivision of Lots 5, 8, 11 of Bingham Tract Pomona, Cal.

Sanders and Moles Surveyors and Civil Engineers Pomona, Cal.
Surveyed Nov. 1887

Scale 60' to 1"

For order vacating certain Streets
See Book 49 Page 39. Misc. Recs.

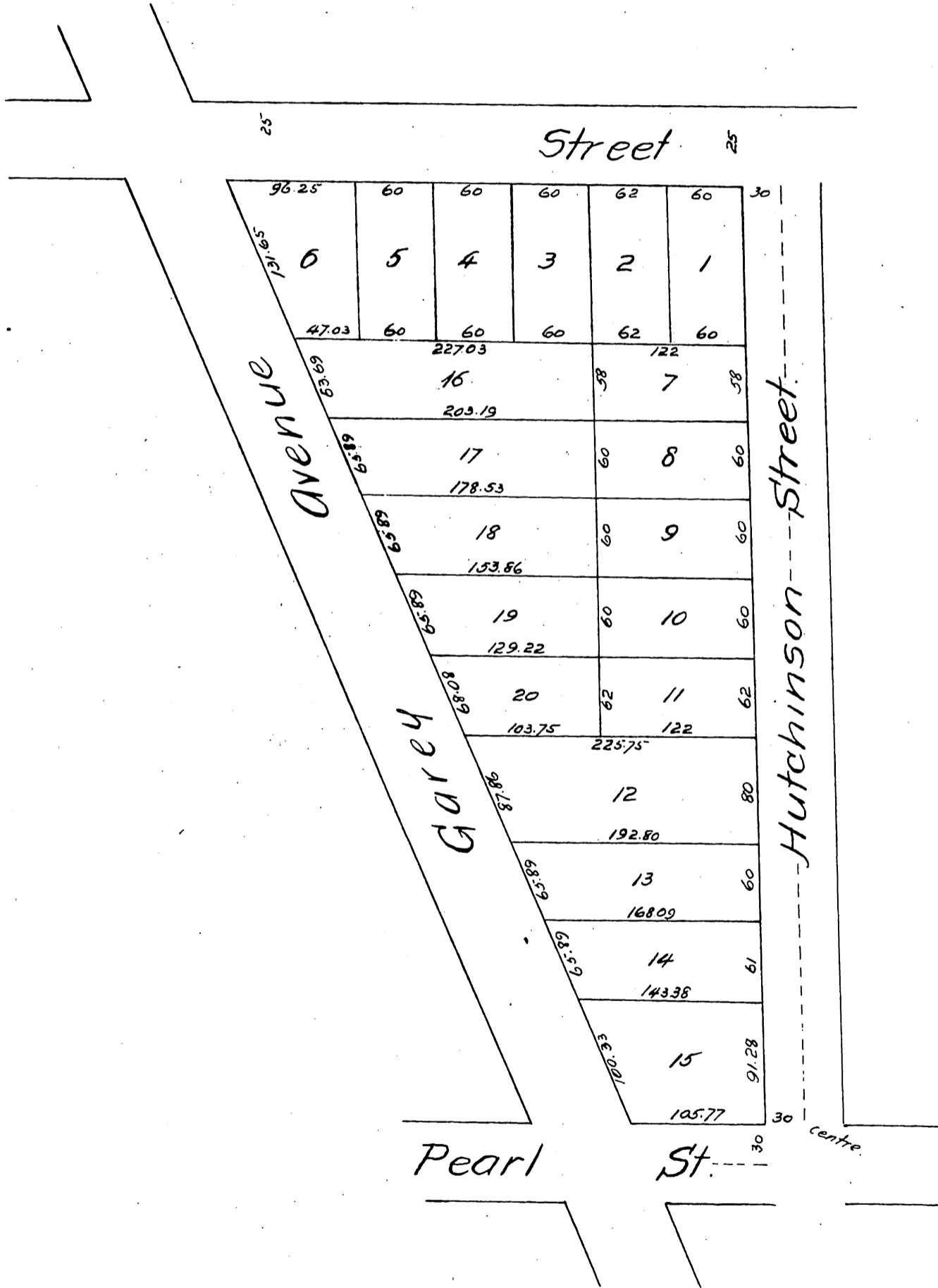

A full, true and correct copy of the original
(reduced to the scale of 100 feet to one inch)
recorded Dec. 1, 1887 at 13 min. past 12 m)
at request of W^m Hutchinson.

Frank O. Gibson County Recorder.
by George Bugbee, Deputy.