

PLAT
OF
Pecks Subdivision
of Block 49 Town of San Pedro.

Scale 100 feet to one inch.

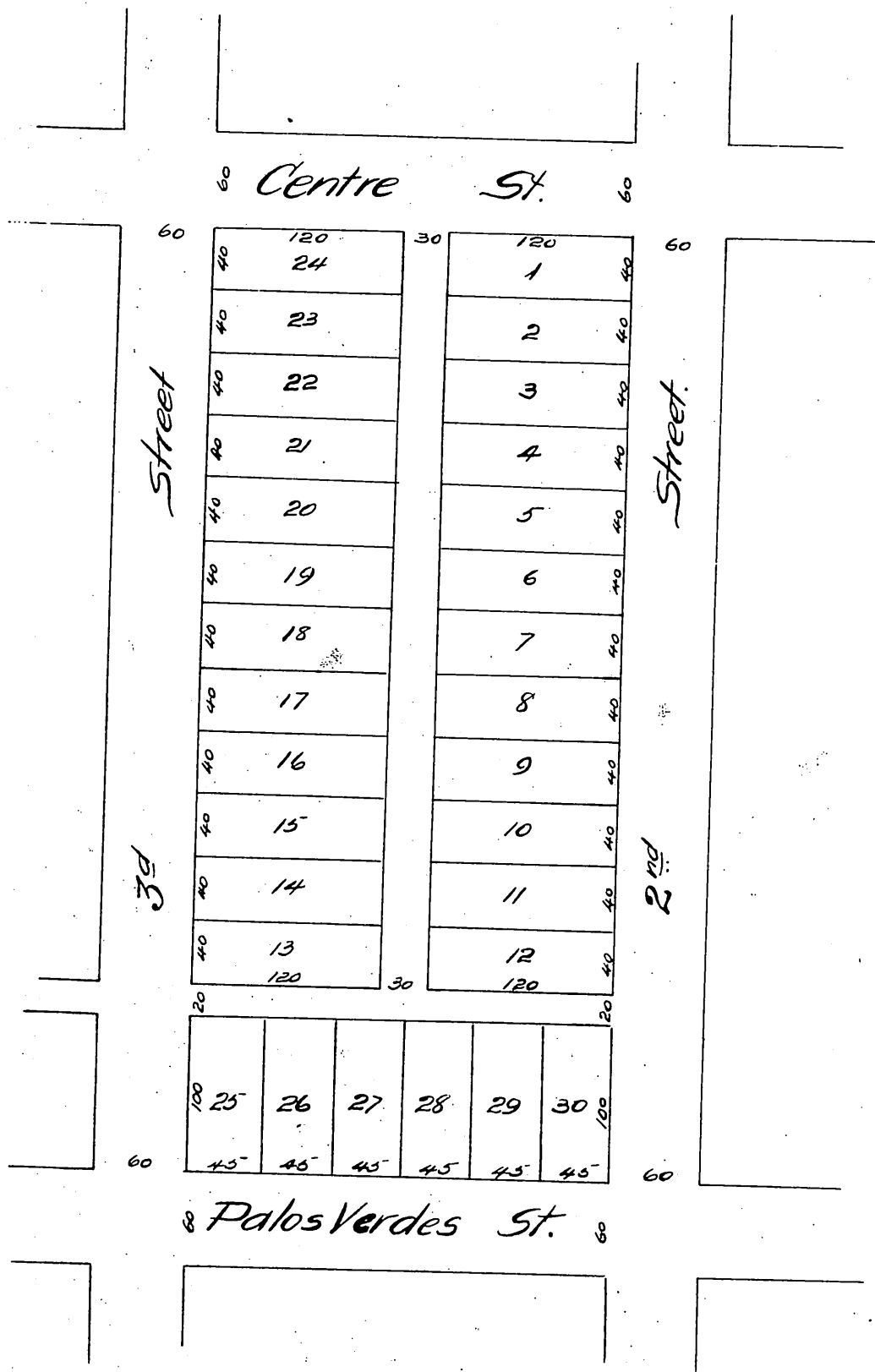

A full, true and correct copy of the original
recorded Dec 6th 1887 at 11²⁰ AM. at request of
G. H. Peck Jr.

Frank A. Gibson County Recorder.
by George Bugbee Deputy.