

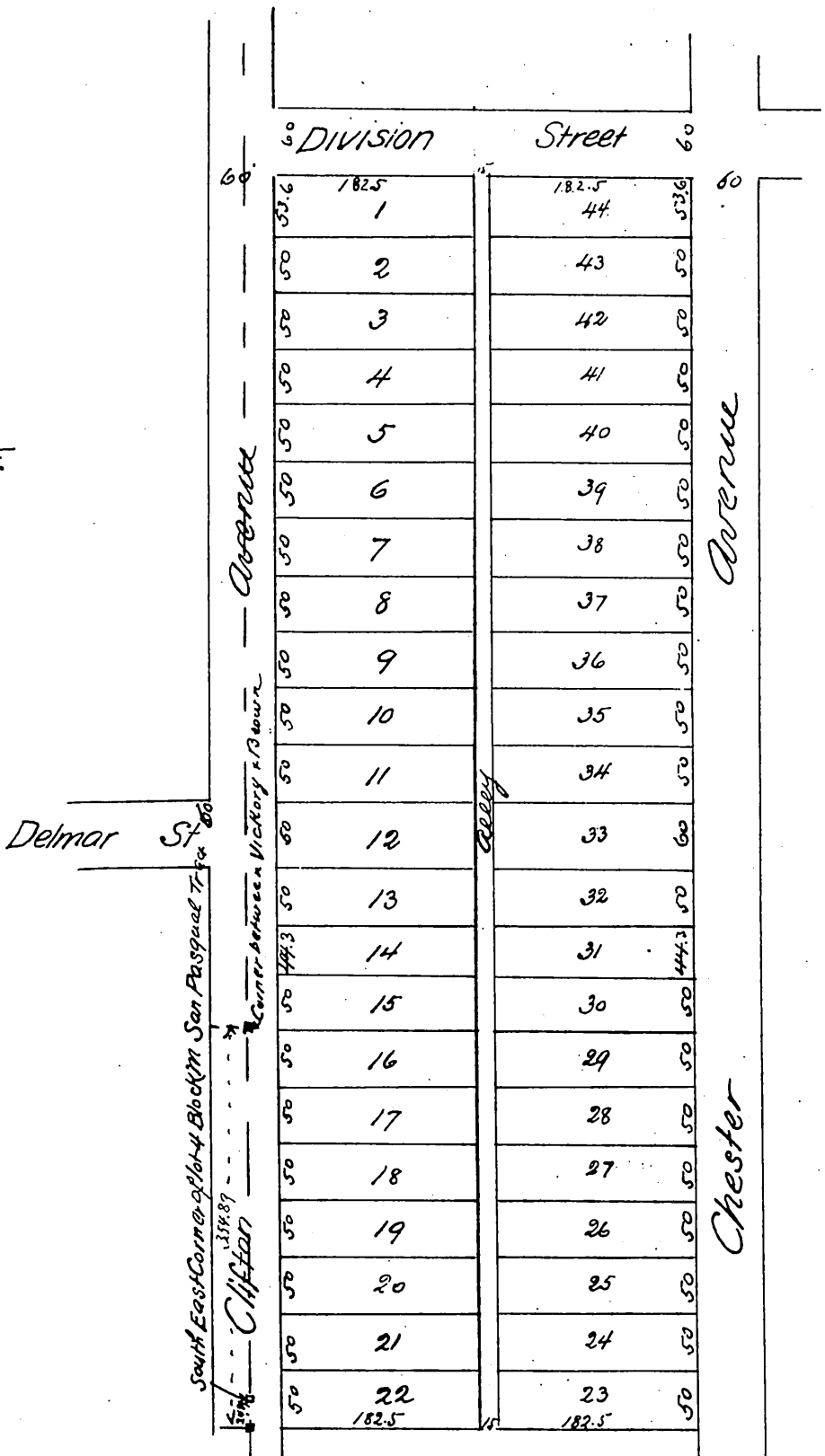

# Map of the

## Deal and Kreiser Subdivision of

the West 10 acres of the tract of 36<sup>35</sup> acres conveyed  
by Geo. M. Briggs and Julia E. Briggs to Mary  
White by deed recorded in Book 167 of  
Deeds page 441, Los Angeles County Cal  
Surveyed by Willard W. Miller Nov. 1887  
Scale 80 feet = 1 inch

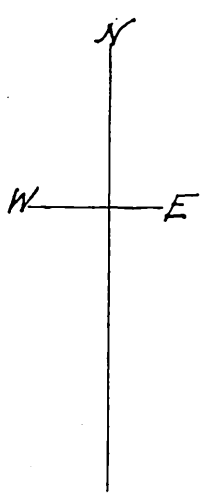

A full true and correct copy of the original (reduced to the scale of 150 feet to one inch) recorded December 13<sup>th</sup> 1887 at 3:30 P.M. at request of John W. Deal

Frank A. Gibson Co. Recorder  
by Wm. E. Johnston Deputy