

Map of the Villa Tract Pasadena

Being a subdivision of a portion of the Cragan Tract
described in deed recorded in Book of Deeds
No 167 Page No 407
Los Angeles Co. Records

Surveyed December 1887. by F. H. Post C.E

Scale 80 feet one inch

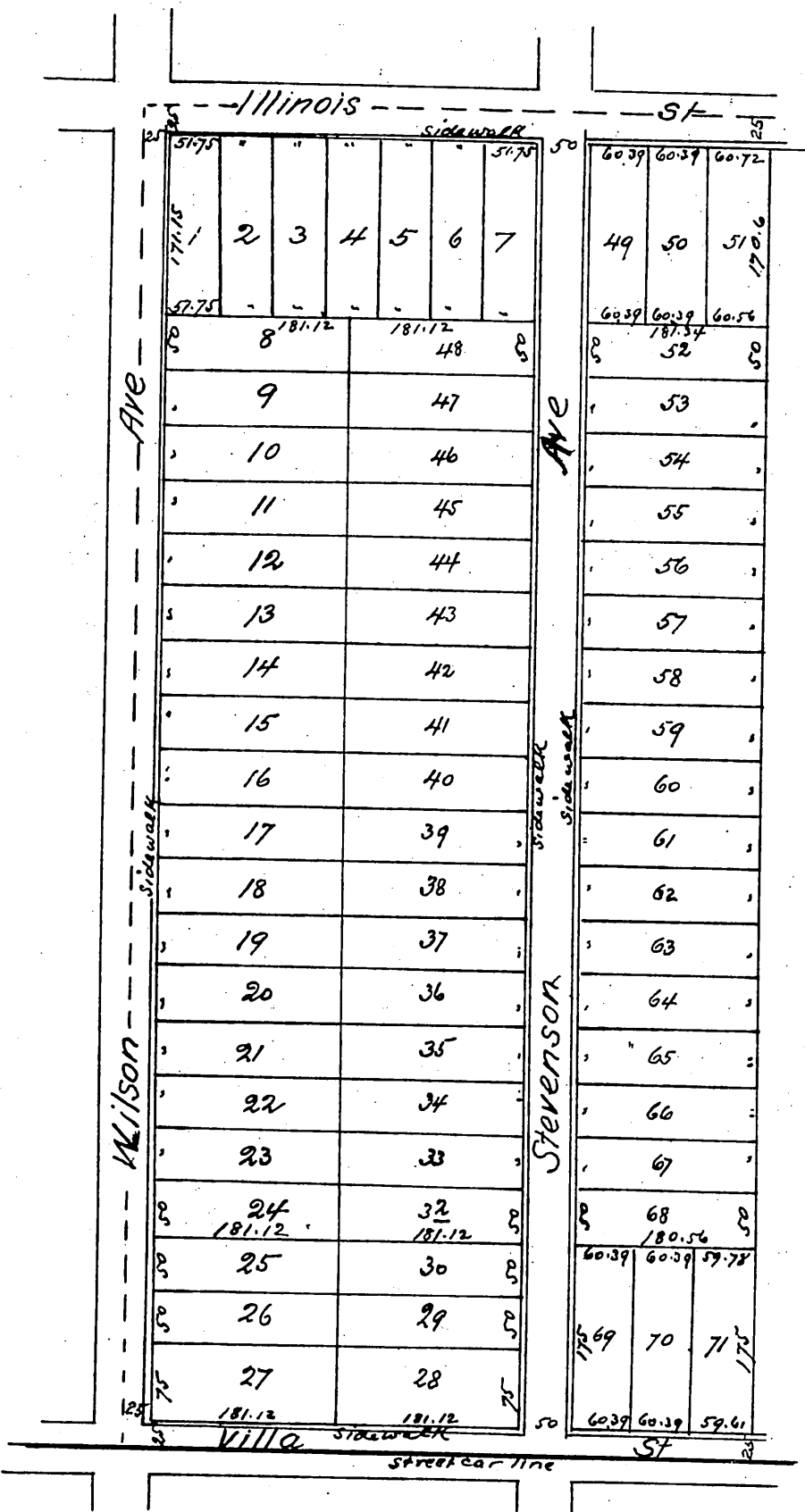

A full, true and correct copy of the original (reduced to the scale of 160 feet to the inch) recorded Dec. 19th 1887 at 11:00 A.M. at request of Road and Hull.
Trunks A. Gilson, County Recorder
By Wm E. Johnston, Deputy.