

Map of the Read Tract Pasadena

Being a subdivision of a portion of the Grogan Tract described
in Deed recorded in book of Deeds No 201 Page 12-205
Los Angeles Co Records
Surveyed December 1887 by F.H. Post C.E.
Scale 80 ft = one inch

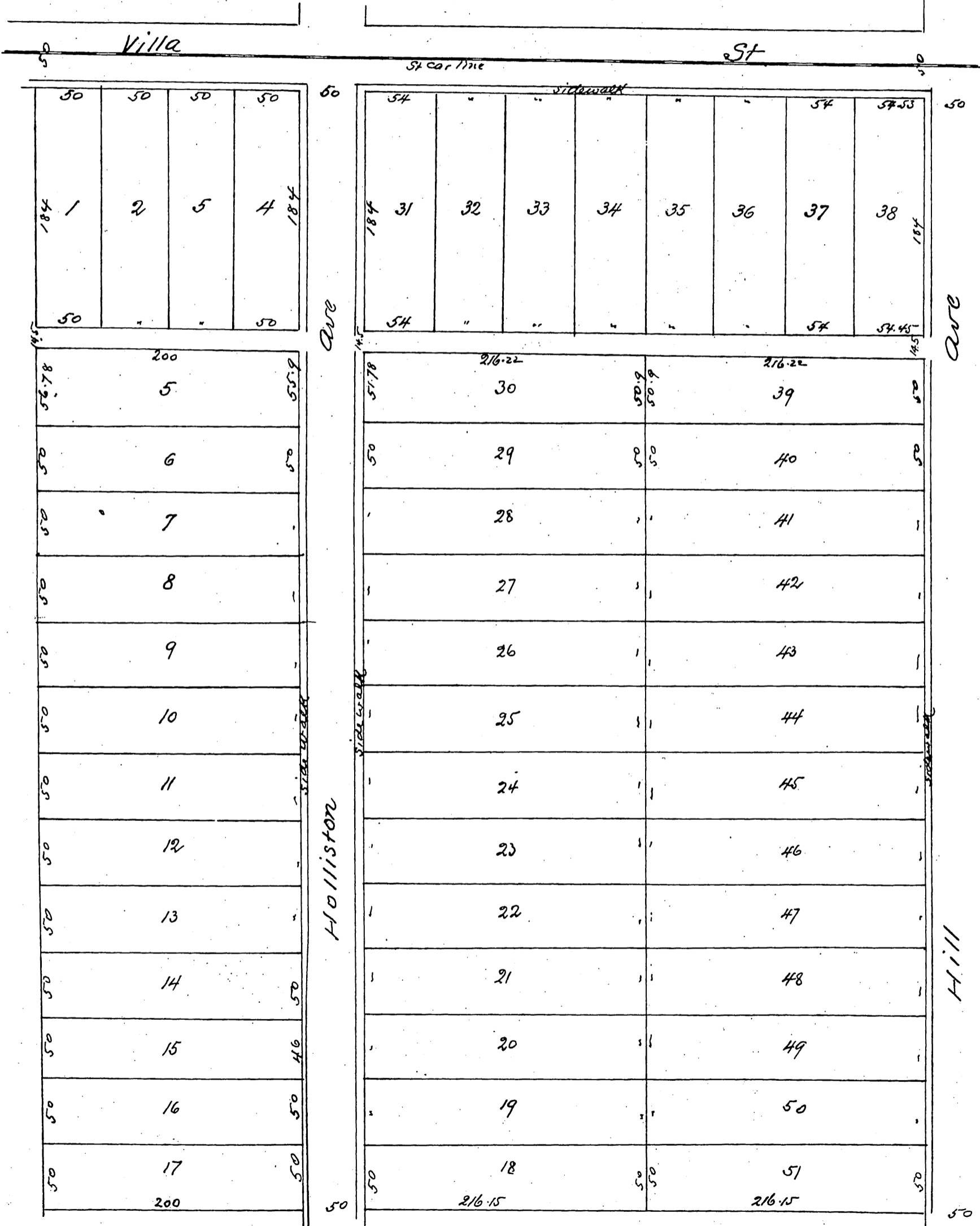

A full true and correct copy of the original
recorded December 19th 1887 at 11:30 A.M.
at request of Read & Hill
Frank A. Gibson C. Recorder
by Wm. E. Johnston Deputy