

Map of Lienau's Cottage Home Tract

Being a tract of Land in Sec 9 of T.2 S.R.13 W
S.B.M. as described in deed recorded on
page 49 book 223 of deeds
Surveyed Dec 1887 by Theo G Koerber
Scale 50 feet to the inch

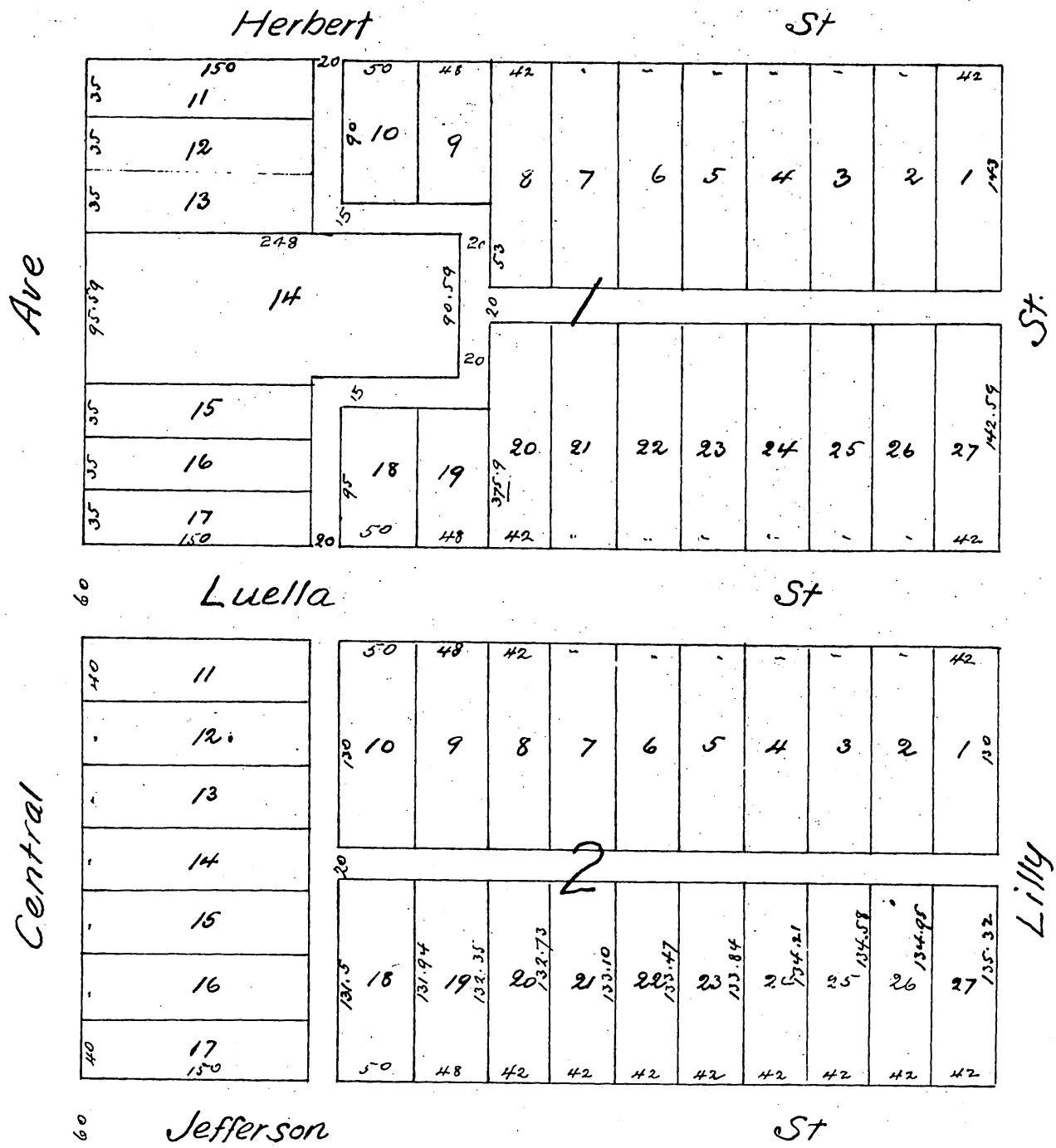

A full true and correct copy of the original (reduced to an exact one half size) recorded December 27th 1887 at 10:20 A.M. at request of C.H. Lienau
Frank A. Gibson County Recorder
by Wm. E. Johnston Deputy