

Map
of
F. Henriot's Subdivision
of the
French School Tract
in the City of
Los Angeles Cala

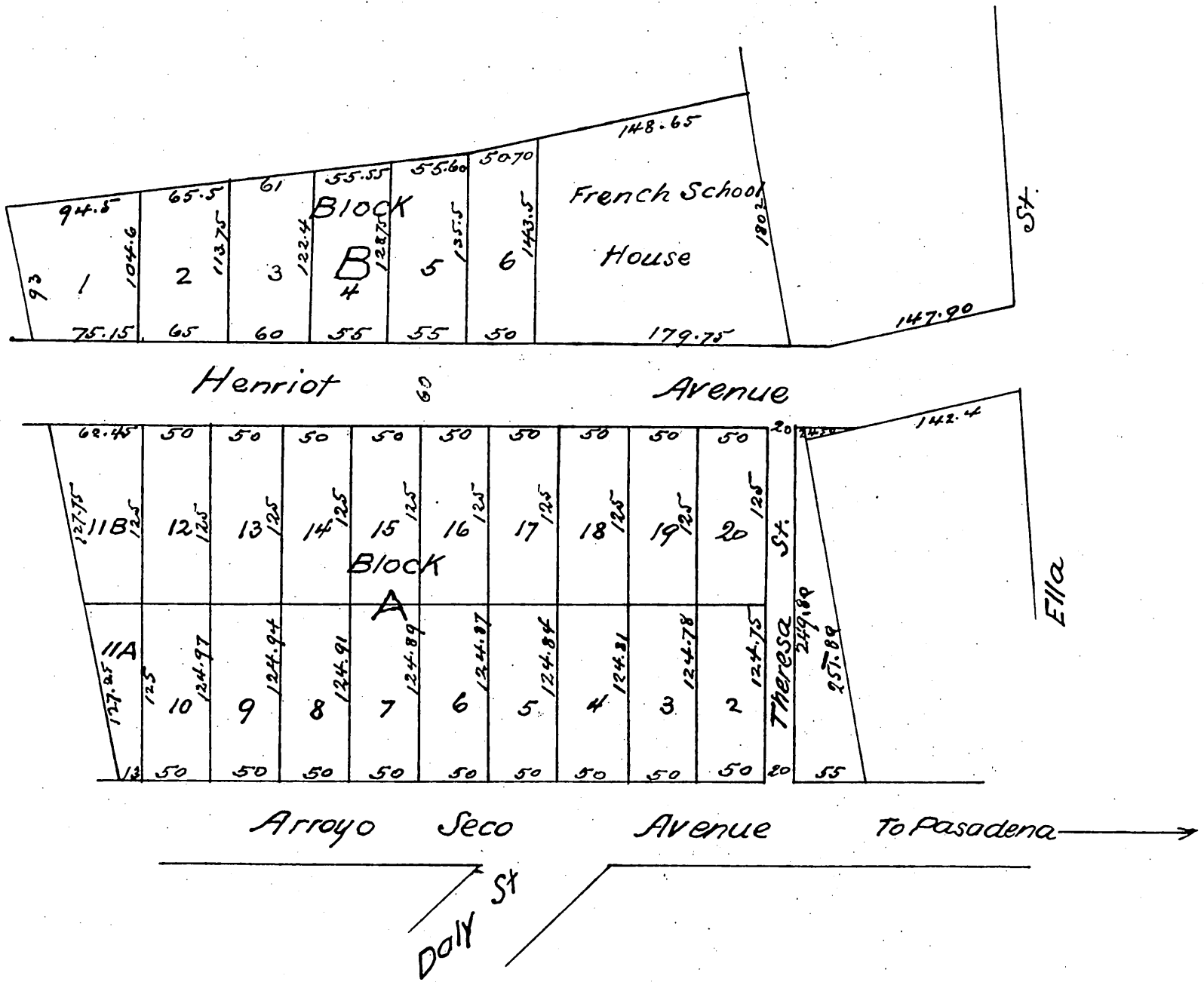

a full true and correct copy of the original (reduced to an exact one half size) recorded Feb. 15th 1888 at 11:20 a.m. at request of F. Henriot
 Frank A. Gibson Co. Recorder
 by Wm E. Johnston Deputy