

# East Claremont

A Subdivision of the NW Quarter of the NE Quarter of  
Section 10 T1 S. R 8 W. S B. M.  
Los Angeles County California

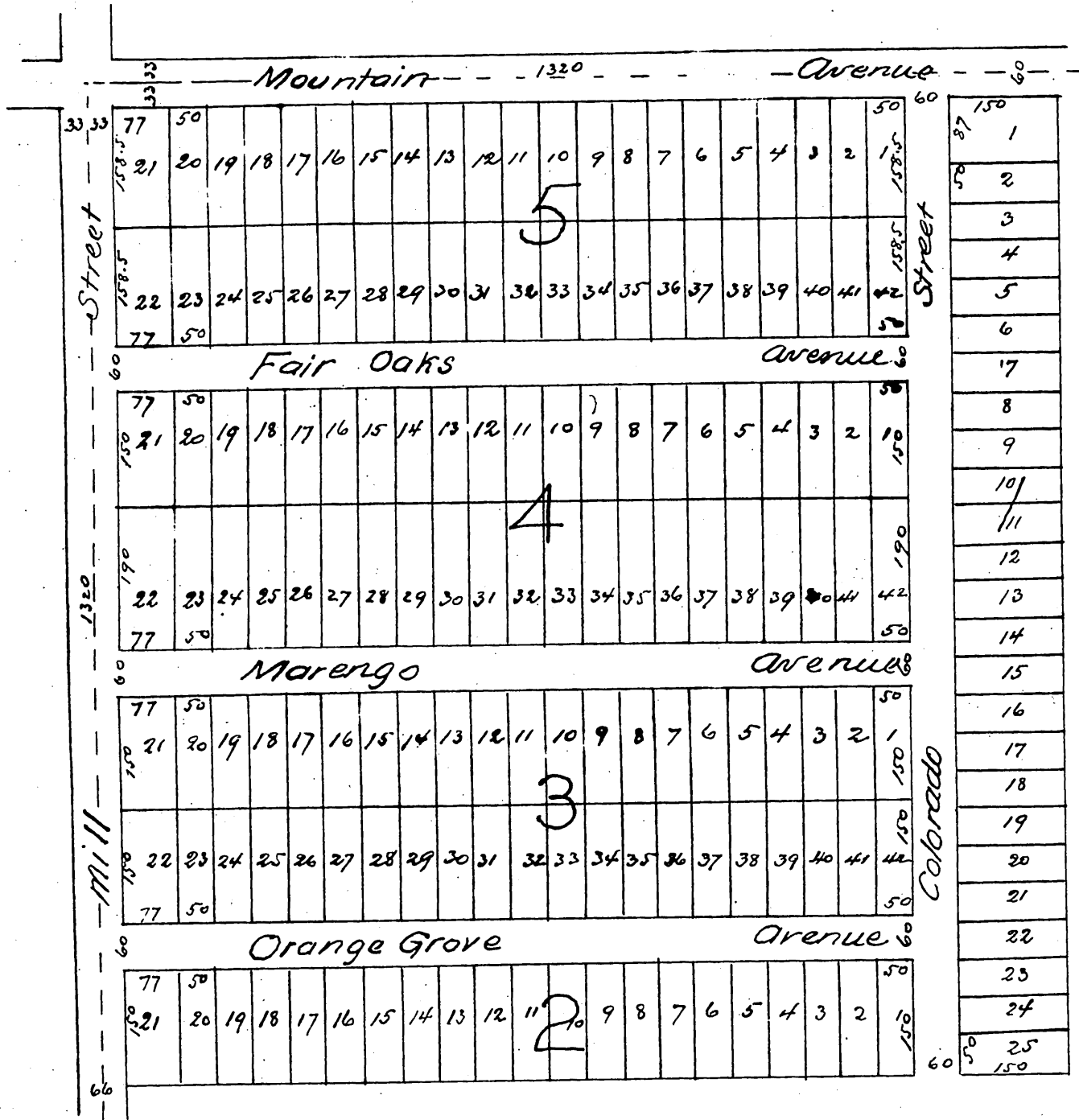

A full true and correct copy of the original (reduced  
to the scale of 300 feet to an inch) recorded Mch  
24th 1888 at 2:43 P. M. at request of Will W Beach  
Frank A Gibson Co. Recorder  
by Wm E Johnston Deputy.