

MAP OF LEHIGH TRACT.

Being the most Westerly $2\frac{1}{2}$ acres of the 10 acres in the $E\frac{1}{2}$
of N.E $\frac{1}{4}$ of Sec 1. T2. S. of R 14. W. S.B.M. as per deed
recorded in the Book of Deeds 132 page 387.

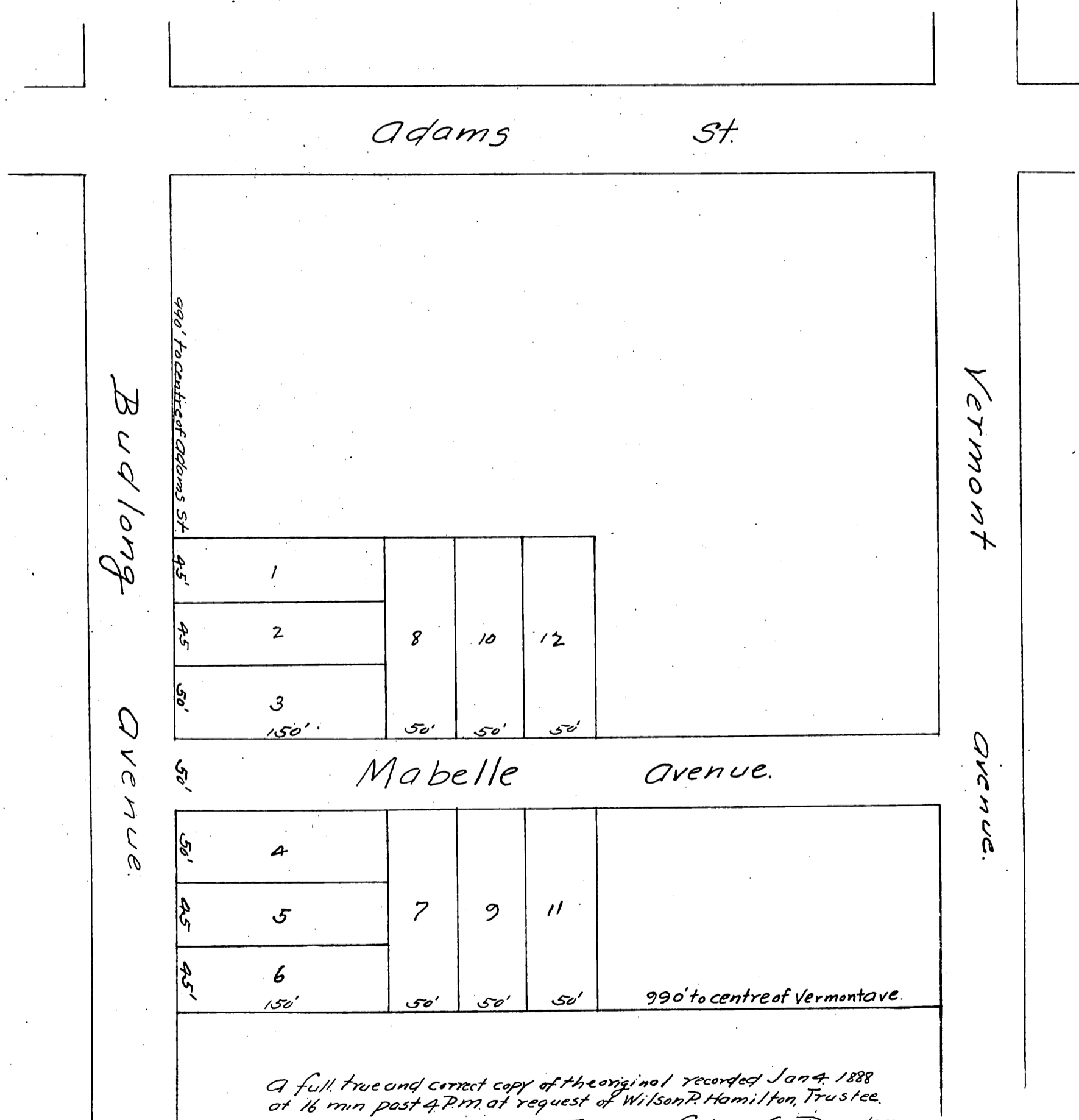

A full, true and correct copy of the original recorded Jan 4, 1888
at 16 min past 4 P.M. at request of Wilson P. Hamilton, Trustee.
Frank A Gibson Co Recorder.
By W² E Johnston, Deputy.