

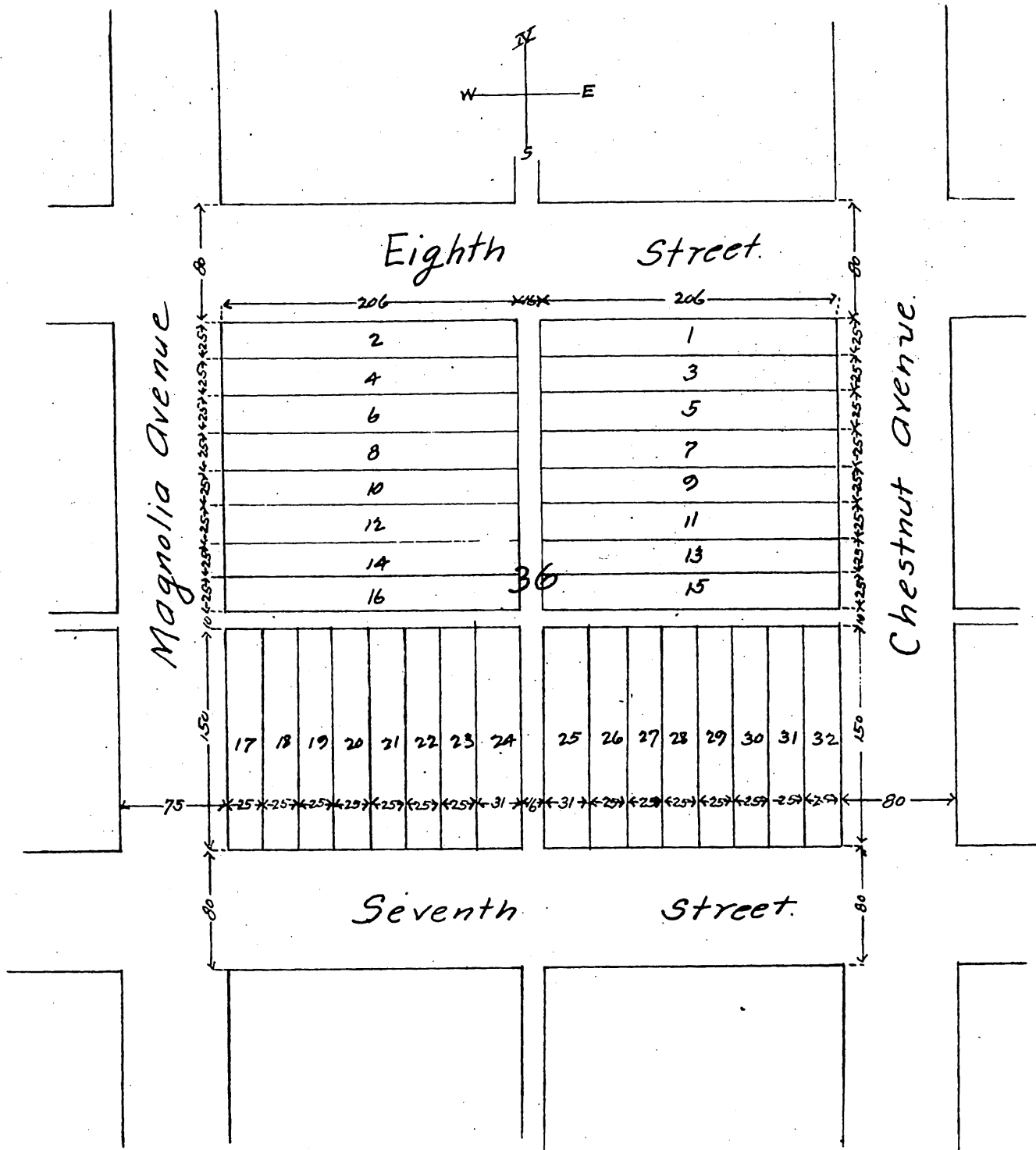

LOWE AND ROBERTS' SUBDIVISION.
 of Block 36,
 LONG BEACH, CAL.

Scale 66 feet to an inch.
 1 chain = 1 inch.

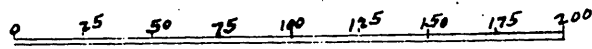

A full true and correct copy of the original (reduced to the scale of 100 feet to one inch) recorded January 5th 1888 at 9.16 a.m. at request of W. W. Lowe.

Frank A. Gibson Co. Recorder.
 By W^m E. Johnston Deputy.