

MAP

OF THE

Lulu Tract

Being part of Lot 7, Block 28 Canal and Reservoir Lands

Los Angeles Cal.

Surveyed Oct 1887 by H.J. Stevenson

Scale 80 feet to one inch

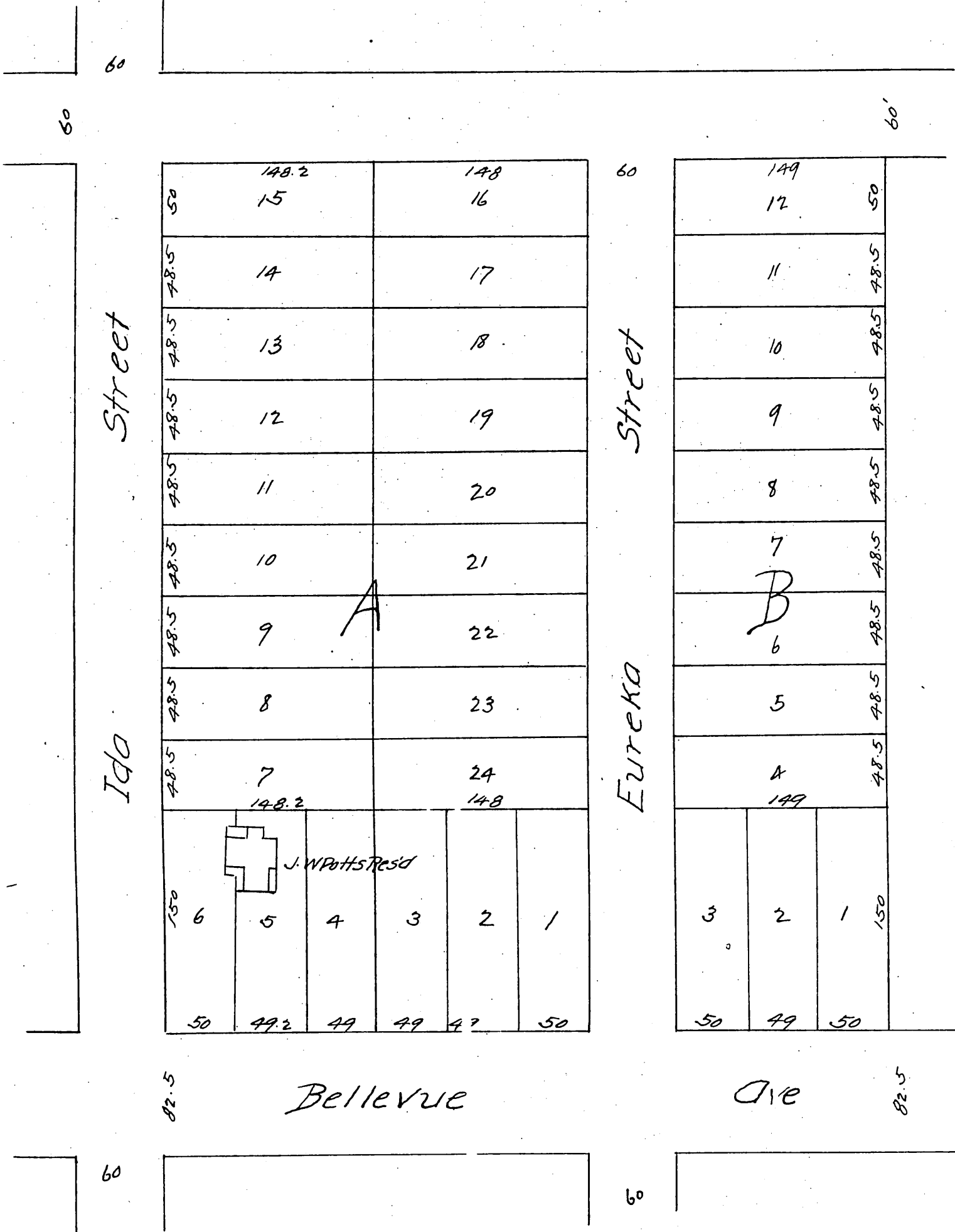
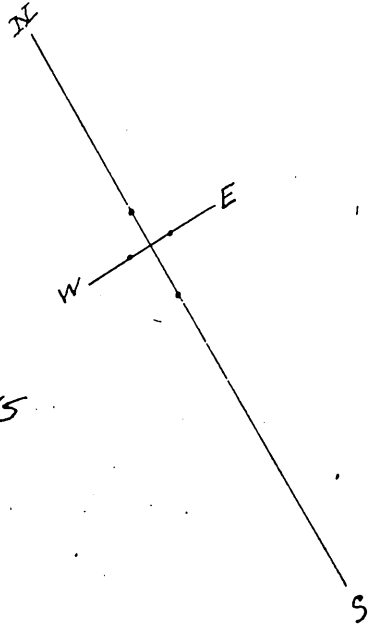

A full, true and correct copy of the original recorded April 21, 1888 at 47 min past 11.0. m at request of J. W. Potts.

Frank O. Gibson County Recorder.
By George Bugbee, Deputy.